

**Operating Instructions
Hand Pallet Truck**

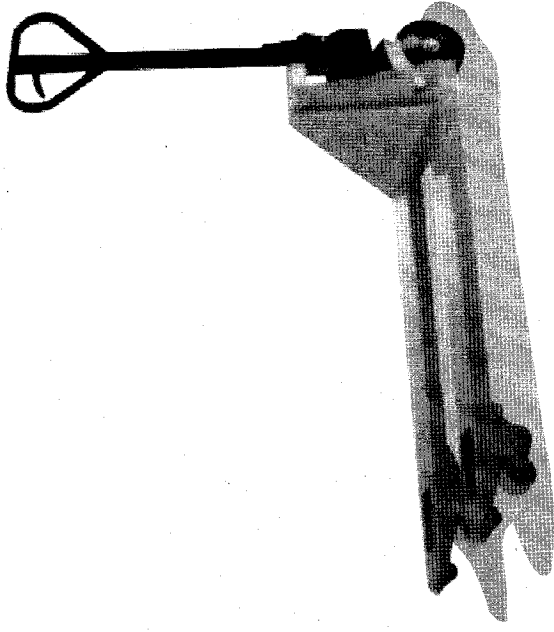

**BEFORE OPERATING THIS PRODUCT, READ
THIS MANUAL AND FOLLOW ALL SAFETY
RULES AND OPERATING INSTRUCTIONS**
Save these instructions for future reference

**BEFORE OPERATING THIS PRODUCT, READ
THIS MANUAL AND FOLLOW ALL SAFETY
RULES AND OPERATING INSTRUCTIONS**
Save these instructions for future reference



GENERAL OPERATION GUIDELINES:

The hand pallet truck was designed to lift and move/transfer palletized loads from one location to another. For optimum safety and performance, loads must be centered evenly across the forks of the truck and operated only on smooth, clean, dry, non-slippery, level surfaces.

Important points to remember:

- Read this entire Operating and Instruction Manual and always follow the guidelines/instructions set forth, regarding this product and be sure to perform service and maintenance as directed for optimal performance and safety.
- Always make sure this vehicle is operated only by trained personnel.
- Never overload or attempt to lift a load, which exceeds the posted load limit of the vehicle.
- Never leave a load on the vehicle when not in use and never allow others to sit, lean or ride on this vehicle while in use or at rest.
- Always keep loose clothing, hands, feet and other body parts clear of moving parts and away from lifted forks/load at all times.
- Always make sure your view is unobstructed in the direction you are moving, and travel at a safe rate of speed on smooth, level surfaces, so as to maintain control of the vehicle at all times.
- Always lower the load slowly and evenly in order to avoid load from shifting off-balance before reaching the ground surface.
- Always avoid forks coming in contact with electrical wires, receptacles, and overhead fixtures, etc.

Reading and following the above operation instructions in no way eliminates the necessity of reading and adhering to the entire Operating Instructions Manual and Safety Rules contained therein, for this vehicle.

Index

1 Introduction

- 1.1 Product description
- 1.2 General information on service and maintenance
- 1.3 Spare parts
- 1.4 Lifting capacity and dimensions

2 Preparation for use

- 2.1 Assembly of handle

3 Operation

- 3.1 Maximum lifting capacity
- 3.2 Danger zones
- 3.3 Service and maintenance

4 Service and maintenance

- 4.1 Periodic inspections
- 4.2 Maintenance
 - 4.2.1 Adjusting of lowering action
 - 4.2.2 Oil level
 - 4.2.3 Lubrication

5 Parts lists

All of the information contained in this handbook is valid as of 10/2009. We reserve the right to make changes and modifications to the product at any time. Should this lead to differences and/or discrepancies, please contact the agency.

1 Introduction

All users must read these operating instructions carefully prior to the initial operation. These instructions are intended to acquaint the user with the truck and enable him to use it to the full extent of its intended capabilities. The operating instructions contain important information on how to handle the truck in a safe, correct and economic way. Acting in accordance with these instructions helps to avoid dangers, reduces repair costs and down time and increases the reliability and longevity of the truck. Anyone involved in doing any of the following work with the truck must read the operation instructions and act accordingly.

- operation, including preparation, trouble shooting during operation and cleaning
- maintenance, inspection, repair
- transport

The manufacturer is to be consulted before any attachments or modifications are made to the truck.

Hand Pallet Trucks

1.1 Product Description

This hand pallet truck has been designed to lift, lower and transport loads over completely level ground. A nameplate on the frame of the pallet truck shows the maximum lifting capacity of 5500 lbs. For the safety of personnel and to prevent damage to the truck, this maximum lifting capacity must never be exceeded. The manufacturer is to be consulted before any attachments or modifications are made to the truck.

1.2 General information on service and maintenance

The working life span, operational reliability and safety of the truck depend greatly on proper service. For this reason the recommended inspections, service and maintenance are to be carried out on time and with great care.

1.3 Spare parts

To eliminate delays, mistakes and to save time and reduce costs, always make the following information available when ordering spare parts:

- Truck model
- Serial number
- Part number
- Part designation
- Number of parts required
- Exact delivery address and means of transport.

We cannot accept any responsibility for the faulty supply of spare parts resulting from insufficient or incorrect data in the spare parts order.

Use only original spare parts.

1.4 Lifting capacity and dimensions in inches

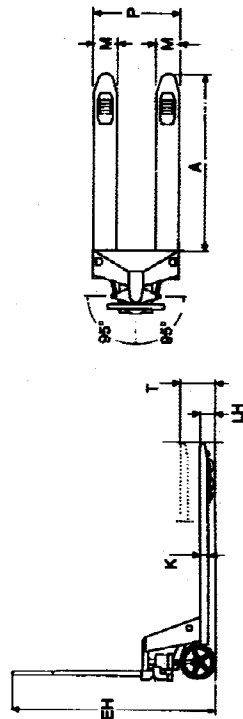

Specifications and sizes

Model	Max. Capacity (lbs)	LH Min. Lowered Fork Height (in)	A Fork Length (in)	K Fork Thickness (in)	M Fork Width (in)	P Overall Fork Width (in)	Weight (lbs)	EH Height of Handle (in)	T Raised Height (in)
27x48	5,500	2.9	48	2.0	5.9	27.0	165	48.4	7.6
27x42	5,500	2.9	42	2.0	5.9	27.0	157	48.4	7.6
27x36	5,500	2.9	36	2.0	5.9	27.0	150	48.4	7.6
20.5x48	5,500	2.9	48	2.0	5.9	20.5	165	48.4	7.6
20.5x42	5,500	2.9	42	2.0	5.9	20.5	157	48.4	7.6
20.5x36	5,500	2.9	36	2.0	5.9	20.5	150	48.4	7.6

To constantly improve our products, specifications may change without notice.

Hand Pallet Trucks

2 Preparation for use:

All trucks are shipped in a cardboard container with the operating handle secured to the frame. Remove the unit from its shipping container, then cut the banding to remove the operating handle. Inspect all components for shipping damage (refer to Fig. 3). Report shipping damage as directed in the shipping documents.

The handle must be assembled to the unit as outlined in par. 2.1 and the lowering action adjustment carried out as directed in par. 4.2.1 prior to placing the unit in service.

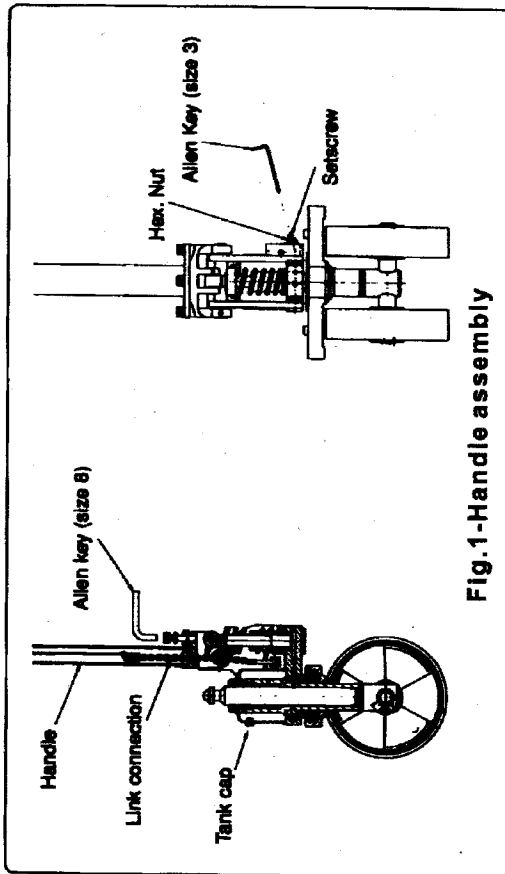

Fig. 1-Handle assembly

2.1 Assembly of the handle (see Fig. 1)

Place the link connection through the bore of the actuating block. Place the handle onto the actuating block and secure with three screws. Attach the link connection to the lever.

3 Operation (see Fig. 1)

The hand pallet truck has been constructed to transport pallets, skeleton boxes, wire mesh pallets, or similar containers, over even, level surfaces. The lifting and lowering hydraulic unit and the steering assembly are protectively incorporated within the welded steel frame. The bearings for the steering and the lifting linkage are also situated there. This construction facilitates access for inspection and service. The hydraulic and steering assemblies form a single compact unit. Steering and the lift and lower operations are controlled from the handle. The load should be positioned equally on both forks and load centre must be between the load and steering wheels, see Fig. 2. The load is to be positioned so that there is no danger of it overturning. The steering has a lock of more than 90° in both directions.

Hand Pallet Trucks

3.1 Maximum lifting capacity

The hand pallet truck was designed to transport loads up to the rated capacity. The capacity indicated on the truck is the maximum safe working load which must not be exceeded.

WARNING

TO AVOID INJURY

- Do not exceed the maximum lifting capacity of hand pallet truck.
- Do not carry personnel on the hand pallet truck.
- Do balance the load evenly on the forks.
- Do not use the hand pallet truck on grades - it does not have a brake.
- Do not lift loads with the fork tips.
- Do keep hands and feet clear of area beneath the lift truck.

Correct

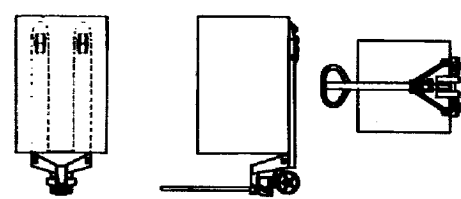

Incorrect

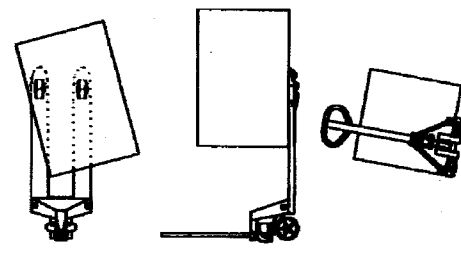

Fig. 2 - Loading the forks

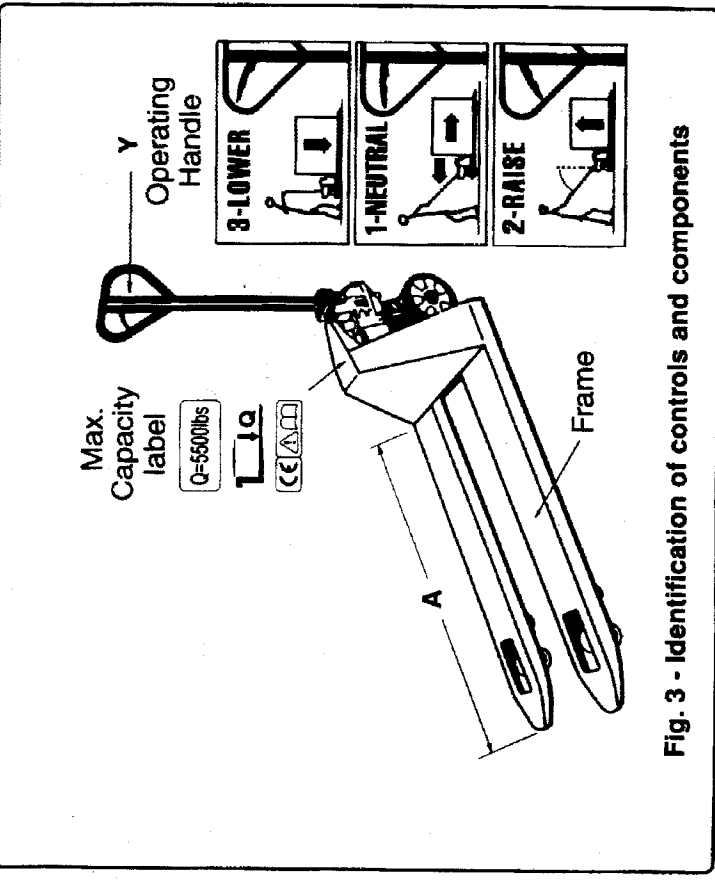

Fig. 3 - Identification of controls and components

3.2 Functions and operation (Up/Down/Neutral, see Fig. 3)

- Up:** Switch the control lever to the "RAISE" position, by pushing the lever away from you, (Fig. 3-Y2) and make several pumping actions with the handle.
- Down:** Switch the control lever to the "LOWER" position, by pushing the lever toward you, (Fig. 3-Y3), until the forks have lowered to the desired position.
- Neutral:** To transport a load the control lever must be in the centre "NEUTRAL" position (Fig. 3-Y1).

3.3 Precautions and danger zones

Do not lift or transport loads while personnel are within the danger zones (in the path of the truck or adjacent to it).

Do not place hands or feet under the raised forks.

Raised loads are not to be left unattended.

The operator may only start to move the load when he is sure the load will not overturn and that all personnel are clear of the danger zones.

Hand Pallet Trucks

4 Service and maintenance

Adhering to the inspection and maintenance instructions is as much a part of the "defined intended use" of the truck as acting in accordance with the operating instructions. If faults are detected the truck must be put out of service immediately.

4.1 Periodic inspection

Periodic inspections are to be carried out by a competent person on a monthly basis unless adverse conditions such as extreme heat, cold, dust, and/or humidity dictate a more frequent inspection.

All components of the truck are to be inspected for damage, wear, corrosion or other irregularities. Repairs may only be carried out by a specialist workshop that uses original spare parts.

4.2 Maintenance

4.2.1 Adjust lowering action

Switch the control lever to the raised position by pushing the lever away from you, (Fig. 3-Y2) and make several pumping actions with the handle until the forks are fully raised. Switch the control lever to the "Neutral" middle position (Fig. 3-Y1). Loosen the hex. nut, see Fig. 1. Slowly turn the setscrew in a clockwise direction until the forks just start to lower. Now turn the setscrew 1-1/2 turns counter-clockwise

Secure the setscrew with the locking nut.

The lowering function must be available in all handle positions.

4.2.2 Oil level (See Fig.1)

Check the oil level every six months (oil viscosity 30 Cst at 40°C)

Important: When adding or replacing oil, always use a good grade of hydraulic jack oil, transmission oil or turbine oil and always avoid mixing different types of oil. Never use brake fluid, alcohol, glycerine, or dirty oil of any kind. Improper oil usage will cause internal damage to the jack.

Replacing oil: Oil should be replaced at least once every year. To drain oil, remove cover plate and oil fill plug. Add oil until level is more than 1/2 inch below hole. Replace oil fill plug and cover plate. Be VERY CAREFUL to not allow dirt or any foreign matter into the system.

Check the oil level as follows:

- Lower the forks completely. Remove the cap (screw, seal washer, and O-ring).
- Remove seal and rubber cover.
- Add oil until it is level with the lower edge of the opening.
- Replace cap. A few pumping actions with the handle will bleed the hydraulic system.

Hand Pallet Trucks

Rust prevention: Clean and wipe with and oily cloth, the piston ram and pump piston, every 3 months or when signs of rust or corrosion appear. When not in use, always leave the saddle and pump piston in the completely lowered (down) position.

4.2.3 Lubrication

The bearings of pins, axles and linkage are to be cleaned and greased (e.g. Shell FD 2 or similar). Check the hydraulic system for leaks and top-off the hydraulic reservoir (max. oil level = bottom edge of filler bore) with forks lowered.

Maintenance Record

Description of service (inspection, oil change, etc.)	Date

Please keep a log of service performed for future reference.

PARTS - Hydraulic

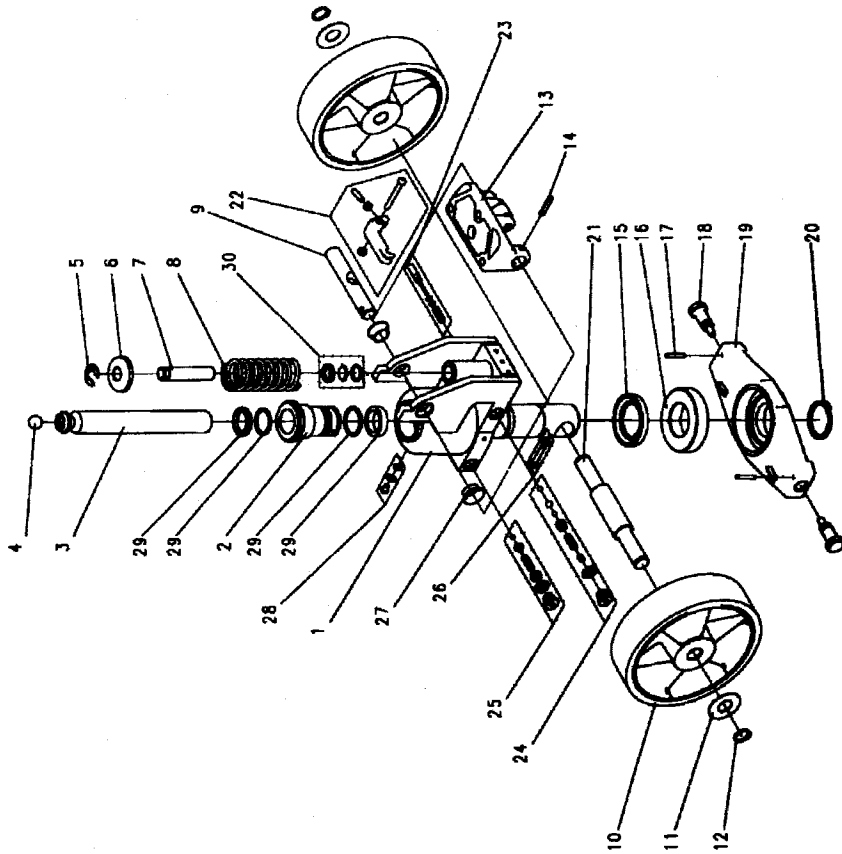

Parts - Hydraulic

Item	Part NO.	Description	Quantity
1		Body.....	1
2		Piston guide.....	1
3		Lifting piston.....	1
4		Ball.....	1
5		Retaining ring.....	1
6		Cap.....	1
7		Pressure piston.....	1
8		Spring.....	1
9		Shaft.....	1
10		Steer wheel PUR.....	2
11		Washer.....	2
12		Retaining ring.....	2
13		Actuating block.....	1
14		Rollpin.....	1
15		Thrust washer.....	1
16		Bearing.....	1
17		Rollpin.....	2
18		Connecting bolt.....	2
19		Bearing plate.....	1
20		Retaining ring.....	1
21		Shaft.....	1
22		Operating lever, assy.....	1
23		Lowering valve, assy.....	1
24		Main valve, assy.....	1
25		Pressure control valve, assy.....	1
26		Fitting.....	1
27		Bushing.....	2
28		Cap (tank).....	1
29		Seal kit (lifting piston).....	1
30		Seal kit (pressure piston).....	1

Hand Pallet Trucks

Parts - Frame

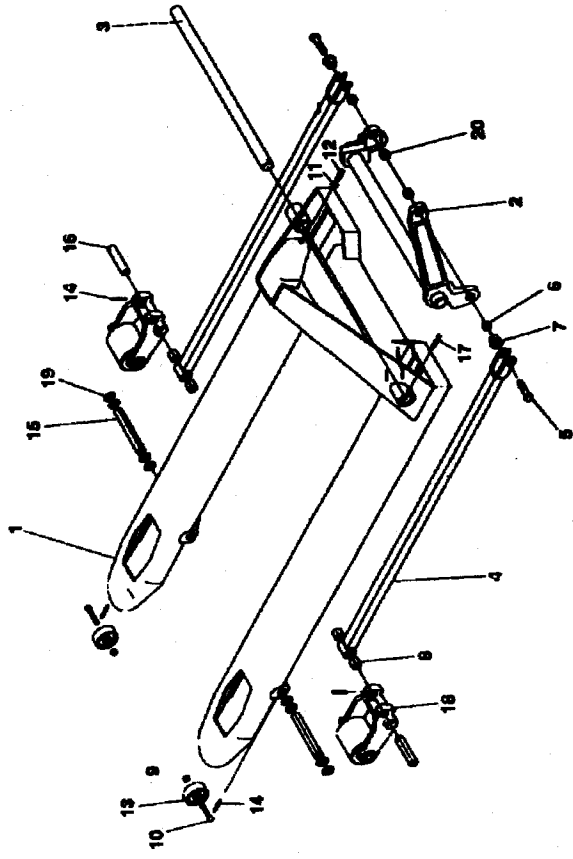

Hand Pallet Trucks

Parts - Frame

Item	Part NO.	Description	Quantity
1.1		Frame(36×20.5) in.....	1
1.2		Frame(40×20.5) in.....	1
1.3		Frame(48×20.5) in.....	1
1.4		Frame(36×27) in.....	1
1.5		Frame(42×27) in.....	1
1.6		Frame(48×27) in.....	1
2.1		Crank(20.5) in.....	1
2.2		Crank(27) in.....	1
3.1		Shaft(20.5) in.....	1
3.2		Shaft(27) in.....	1
4.1		Link(36) in.....	2
4.2		Link(42) in.....	2
4.3		Link(48) in.....	2
5		Screw.....	2
6		Screw with clamping element.....	2
7		Eccentric.....	2
8		Bushing.....	4
9		Screw with clamping element.....	2
10		Screw.....	2
11		Nut.....	1
12		Set screw.....	1
13		Entry roller.....	2
14		Rollpin.....	4
15		Shaft(frame/LRG).....	2
16		Shaft(link/LRG).....	2
17		Rollpin.....	1
18		Load roller, tandem.....	2
19		Shim washer.....	8
20		Bushing.....	2

Hand Pallet Trucks

Parts - Load roller, tandem

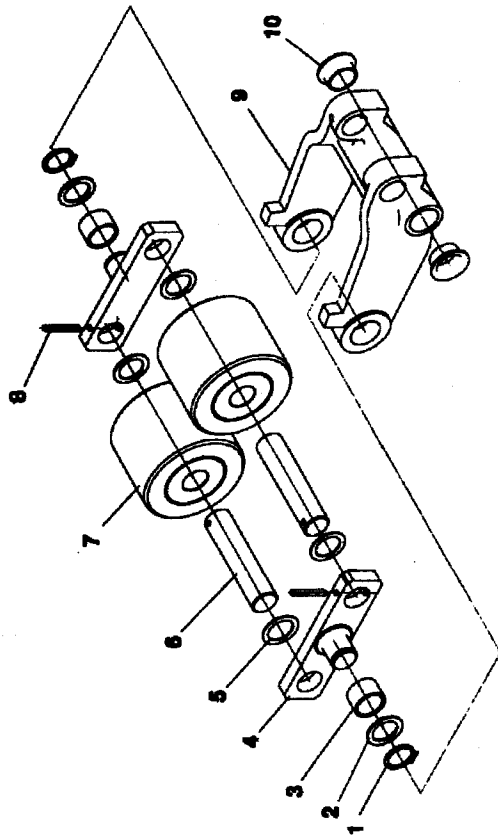

Item	Part NO.	Description	Quantity
1		Retaining ring.....	2
2		Shim washer.....	2
3		Bushing.....	2
4		Link.....	2
5		Shim Washer.....	4
6		Shaft (load roller T).....	2
7		Tandem load roller PUR.....	2
8		Rollpin.....	2
9		Load roller fork, tandem.....	1
10		Bushing.....	2

Hand Pallet Trucks

Parts - Handle

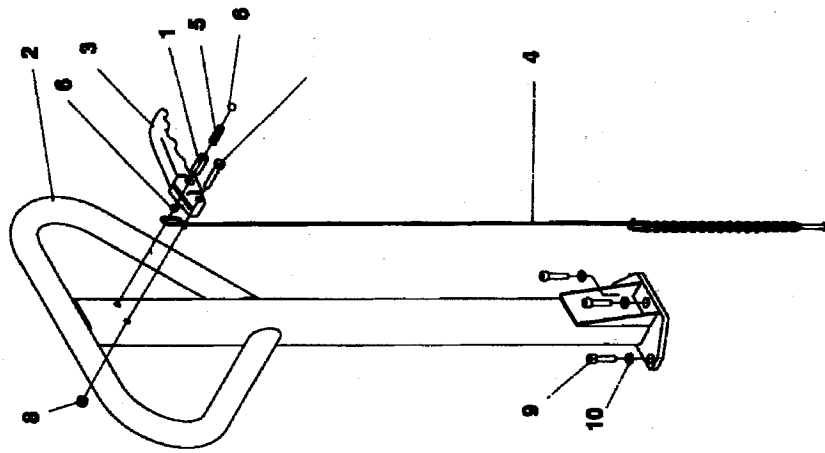

Item	Part NO.	Description	Quantity
1		Sleeve.....	1
2		Handle.....	1
3		Lever.....	1
4		Link connection.....	1
5		Spring.....	1
6		Ball 8 mm.....	1
7		Screw.....	1
8		Screw with clamping element.....	1
9		Screw.....	1
10		Lockwasher.....	1