

# HYUNDAI

## LOG SPLITTER HYLS15520T

---

**User Manual**

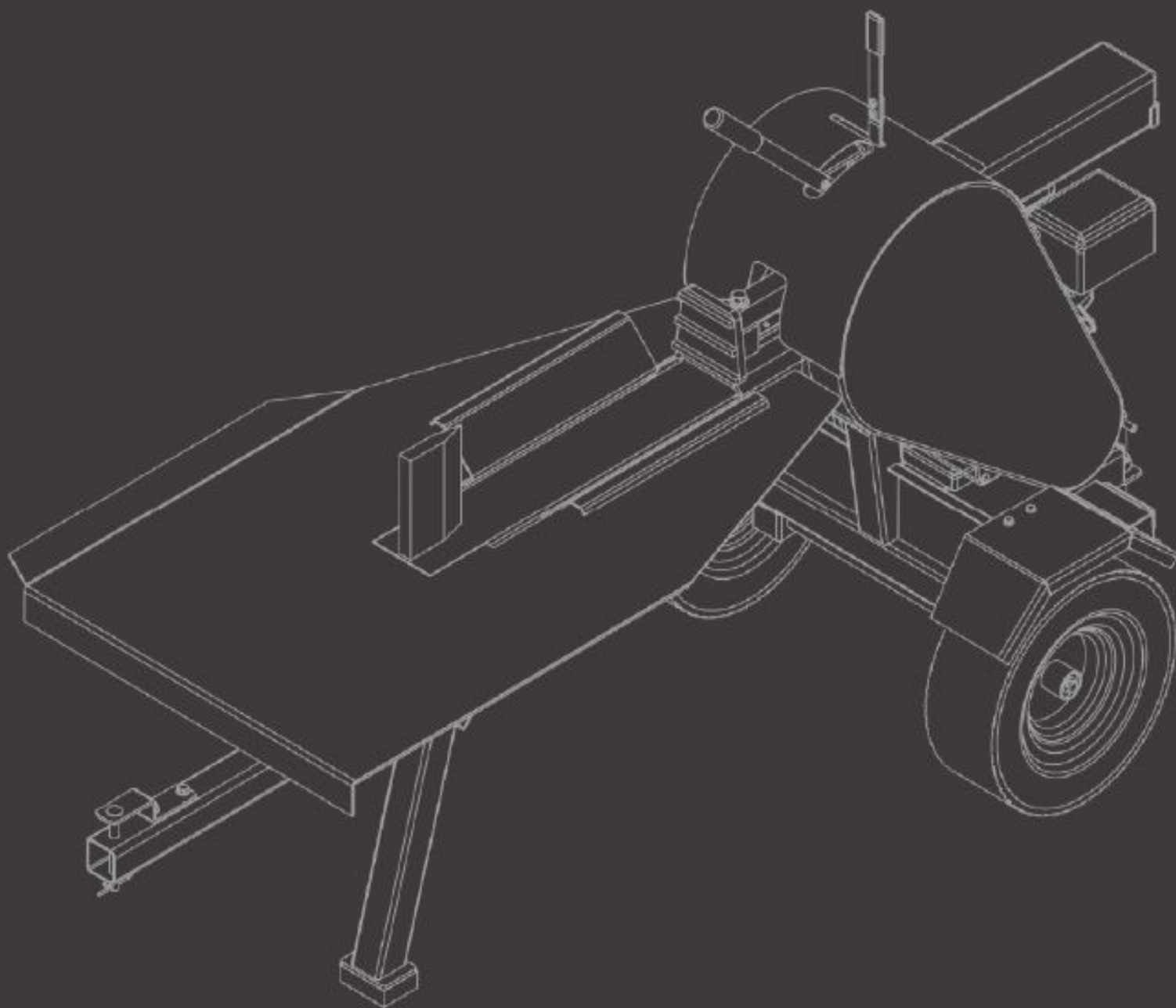

# INDEX

	<b>CONTENTS</b>	<b>PAGE NO.S</b>
1	SAFETY	3 - 8
2	PART LOCATIONS	9 - 10
3	ASSEMBLY	11 - 14
4	PRE-OPERATION CHECKS	15 - 16
5	STARTING PROCEDURE	17 - 19
6	STOPPING PROCEDURE	20
7	OPERATING INSTRUCTIONS	21 - 22
8	MAINTENANCE	23 - 29
9	TRANSPORTING	29
10	TROUBLESHOOTING	30 - 31
11	SPECIFICATION	32
12	RECYCLING AND PRODUCT DISPOSAL	33
13	DECLARATION OF CONFORMITY	34
14	CONTACT DETAILS	35

# 1. SAFETY

## 1.1 General Safety Notes.

- 1.2 The operator of the machine is responsible for, and has a duty of care in making sure that the machine is operated safely and in accordance with the instructions in this user manual. Keep the manual safe and pass it on if the machine is loaned or sold to another user.
- 1.3 Please note the following safety points.
- 1.4 The machine should never be left it in a condition which would allow an untrained or unauthorised person/s to operate this machine.
- 1.5 All due care and diligence should be taken by the operator for the safety of and with regard to those around whilst using the machine.
- 1.6 Some or all of the following - warning signs, symbols and/or PPE pictograms may appear throughout this manual. You **MUST** adhere to their warnings. Failure to do so may result in personal injury to yourself or those around you.



## DANGER

Indicates a hazard, which, if not avoided, could result in serious injury or death.



## WARNING

Indicates a hazard, which, if not avoided, could result in serious injury.



## CAUTION

Indicates a hazard which, if not avoided, might result in minor or moderate injury.



## NOTE

Indicates a situation that could easily result in equipment damage.

READ and keep the manual safe and pass it on if the machine is loaned or sold to another user.

You **MUST** fully understand all instructions to ensure you use and operate the machine safely.

Appropriate Personal Protective Equipment (PPE), **MUST** be worn at all times when operating or repairing the machine.



HAND  
PROTECTION  
MUST BE WORN



EYE  
PROTECTION  
MUST BE WORN



PROTECTIVE  
CLOTHING  
MUST BE WORN



HEARING  
PROTECTION  
MUST BE WORN



FOOT  
PROTECTION  
MUST BE WORN



HEAD  
PROTECTION  
MUST BE WORN



RESPIRATOR  
MUST BE WORN



FACE SHIELD  
MUST BE WORN

## 1.10 Carbon Monoxide (where applicable).

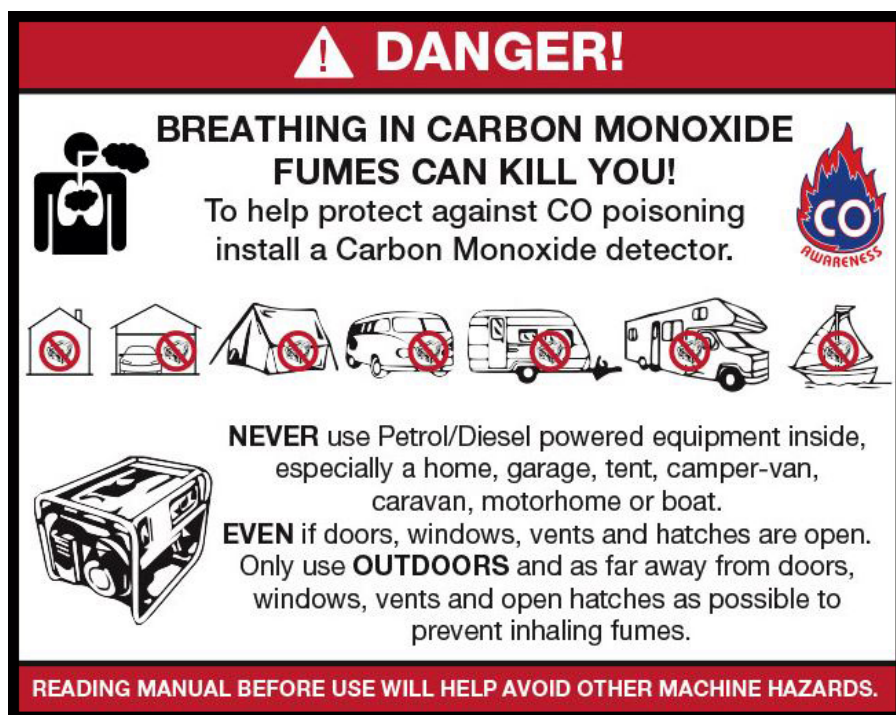

- 1.11 Carbon monoxide is a colourless and odourless gas. Inhaling this gas can cause death as well as serious long term health problems such as brain damage.
- 1.12 The symptoms of carbon monoxide poisoning can include but are not limited to the following;  
Headaches, dizziness, nausea, breathlessness, collapsing or loss of consciousness.
- 1.13 Carbon monoxide poisoning symptoms are similar to flue, food poisoning, viral infections and simply tiredness. It is quite common for people to mistake this very dangerous poisoning for something else.
- 1.14 To avoid carbon monoxide poisoning **DO NOT** use Petrol/Diesel powered equipment inside any of the following; Home, garage, tent, camper van, mobile home, caravan or boat. This is not exhaustive and if you are in any doubt contact your dealer.
- 1.15 If you think you have or someone around you has been affected by carbon monoxide poisoning;
- 1.16 Get them fresh air immediately, by leaving the affected area or by opening doors and windows. If safe and practical to do so make sure that the machine is turned off.  
**DO NOT** enter a room you suspect of having carbon monoxide present – instead call the emergency services.
- 1.17 Contact a Doctor immediately or go to Hospital – let them know that you suspect carbon monoxide poisoning.
- 1.18 **DO NOT** use in an enclosed area or moving vehicle.

## 1.20 General Fuel Safety (where applicable).



### CAUTION

#### ALL FUELS ARE FLAMABLE

1.21 Fire Hazard – keep fuel away from all sources of ignition for example heaters. Lamps, sparks from grinding or welding.



1.22 **DO NOT** carry out hot work on tanks that have contained fuel.

1.23 **ALWAYS** keep the work area tidy.

1.24 **ALWAYS** clean up spills promptly using absorbent granules and a lidded bin.

1.25 **ALWAYS** dispose of waste fuels correctly.

## 1.30 Fueling/De-fueling (where applicable).



### CAUTION

#### ALL FUELS ARE FLAMABLE

1.31 **ALWAYS** fuel and defuel in a well ventilated area outside of buildings.

1.32 **ALWAYS** wear correct, suitable and fit for purpose Personal Protective Equipment (PPE), suggested items are but not limited to safety gloves, overalls.



1.33 When fueling/de-fueling **ALWAYS** avoid inhaling fumes.

1.34 When de-fueling **ALWAYS** use a proper fuel retriever.



1.35 **ALWAYS** carry fuel in the correct and clearly marked container.

## 1.40 Electrical Safety (where applicable).

1.41 Electricity can kill – **NEVER** work on **LIVE/ENERGISED** equipment.

1.42 Prior to carrying out any maintenance work you **MUST** identify electrical isolation methods and isolate all electrical supplies.

1.43 Prior to use and with all electrical supplies isolated, you **MUST** check all electrical cables, plugs and connectors for the following;

1.44 Are intact and have no signs of damage, to include but not limited to bare wires, chaffing, cuts and loose wiring.

1.45 If there are any signs of damage, the damaged item **MUST** be taken out of service until the damage has been repaired by an electrically competent person.

1.46 All trailing cables should be routed so as not to cause any kind of trip hazard.

1.47  **NEVER** work on or near electricity with wet hands, wet clothing and wet gloves.

## 1.50 Batteries (where present).

1.51 Batteries present a risk if they become damaged by the possible leaking of electrolyte. This electrolyte is an acid and can cause serious burn injuries. Care should be taken when working on or near them. **NOTE** the electrolyte may be in a liquid or gel form.

1.52 Should you come in to contact with electrolyte you should;

1.53 Remove all clothing contaminated with electrolyte. If you cannot remove then saturate them in water.

1.54 Get medical assistance as soon as possible. You must advise the medical staff of the type of acid.

1.55 Lead/acid battery = dilute sulphuric acid.

1.56 Nickel/cadmium = potassium hydroxide alkali electrolyte.

1.57 Use fresh running water to wash off excess electrolyte, continue this until medical assistance arrives. Make sure that you do not wash the electrolyte to another part of your body or face.

1.58 If electrolyte comes in to contact with Eyes the electrolyte needs to be immediately washed away with large amounts of water. Make sure that you do not wash the electrolyte to another part of your face or body.

1.59 Gasses from charging batteries are highly flammable and great care should be taken to charge in well ventilated areas.

1.59.1  There is an explosion risk if the battery terminals are short circuited, when connecting/disconnecting **ALWAYS** exercise great care so that the terminals or battery leads are **NOT** allowed to touch and cause a spark. **ALWAYS** use suitable insulated tools.

## 1.60 Vibrations (where applicable).

1.61 Prolonged use of hand held (operated) machines will cause the user to feel the effects of/from vibrations. These vibrations can lead to white finger (Raynaud's phenomenon) or carpal tunnel syndrome. This condition reduces the ability of the hand to feel and regulate temperature, causing numbness and heat sensations and may cause nerve damage and circulatory tissue death.

1.62 Not all factors that lead to white finger disease are known, but cold weather, smoking and other diseases that affect blood vessels and blood circulation as well as large and long-lasting impact of shocks are considered factors in the formation of white finger. Note the following to reduce the risk of white finger and carpal tunnel syndrome;

1.63 Wear gloves and keep your hands warm.

1.64 Take regular breaks.

1.65 All of the above precautions may help reduce the risk of white finger disease but not rule out the carpal tunnel syndrome. Long-term and regular users are therefore

recommended to observe the condition of your hands and fingers. Seek medical attention immediately if any of the above symptoms should occur.

## **1.70 Noise (where applicable).**

- 1.71 The operating noise of the machine can damage your hearing. Wear hearing protection such as earplugs or ear defenders to protect your hearing. Long-term and regular users are advised to have hearing checked regularly. Be especially vigilant and cautious when hearing ear protection because your ability to hear alarm warnings will be reduced.
- 1.72 Noise emissions for this equipment is unavoidable. Carry out noisy work at approved times and for certain periods. Limit the working time to a minimum. For your personal protection and protection of people working nearby it is also advisable for them to wear hearing protection.
- 1.73  See Certificate of Conformity section for Outdoor Noise declaration of conformity.

## **MACHINE SPECIFIC SAFETY**

### **1.80 General Machine Safety.**

- 1.81 Read the owner's manual carefully to understand how to operate this machine properly.
- 1.82 You should **NEVER** use the machine when;
- 1.83 Wearing loose clothing, barefoot or sandals.
- 1.84 Under the influence of drink or drugs or as a result of having taken medication for cold or flu, or any other times when a possibility exists that your judgement might be impaired or that you might not be able to operate the machine properly and in a safe manner.
- 1.85 Suffering from exhaustion or lack of sleep.
- 1.86 When the ground is slippery or when other conditions exist which might make it not possible to maintain a steady posture.
- 1.87 At night, at times of heavy fog, or at any other times when your field of vision might be limited and it would be difficult to gain a clear view of the area.
- 1.88 During rain storms, lighting storms, at times of strong or gale force winds, or at any other times when the weather conditions might make it unsafe to use this product.
- 1.89 **NEVER** run the engine indoors. The exhaust gasses contain harmful carbon monoxide.
- 1.90 When using this machine for the first time and before actual work, you **MUST** learn how to handle the machine from an experienced or skilled person.
- 1.91 Limit the amount of time using the machine continuously to somewhere around 10 minutes per session and take 10 to 20 minutes of rest between sessions. Also try to keep the total amount of work in a single day limited to 2 hours or less.



- 1.92 **NEVER** allow children or anyone unable to fully understand the directions given in this manual to operate this product.
- 1.93 Make sure you keep this manual handy so you may refer to it whenever questions arise and ensure you pass this manual on if the machine is loaned or sold.
- 1.94 Correct Personal Protective Equipment (PPE) **MUST** be worn at all times when operating or repairing this machine. This should include but is not limited to;



- 1.95 Do not use this machine inside a confined space such as but not limited to a vehicle, house, garage, container, boat or building. Only use outside in a well ventilate area.
- 1.96 For air cooling a minimum of 1m is required all around the machine.  
Maximum ambient temperature 40 degrees Celsius.
- 1.97 Fire risk- Fuel can expand and overflow in a hot environment or moving vehicle.
- 1.98 Explosion risk- LPG/ Petrol can leak and the vapour is heavier than air. Never store in confined spaces especially in a boat where the vapour/has will accumulate in the hull and create a high risk of explosion.
- 1.99 Carbon monoxide poisoning risk- Never run an engine in a confined space or poorly ventilated area. Keep machine away from windows to prevent fumes entering the internal space. Carbon monoxide is produced by the engine and contained in the exhaust fumes. You cannot see it or smell it and it can kill you in minutes.
- 1.99.1 Never use inside a confined space with an exhaust extension. If the exhaust extension fails the escaping exhaust gases could kill you.



## 2. PART LOCATIONS

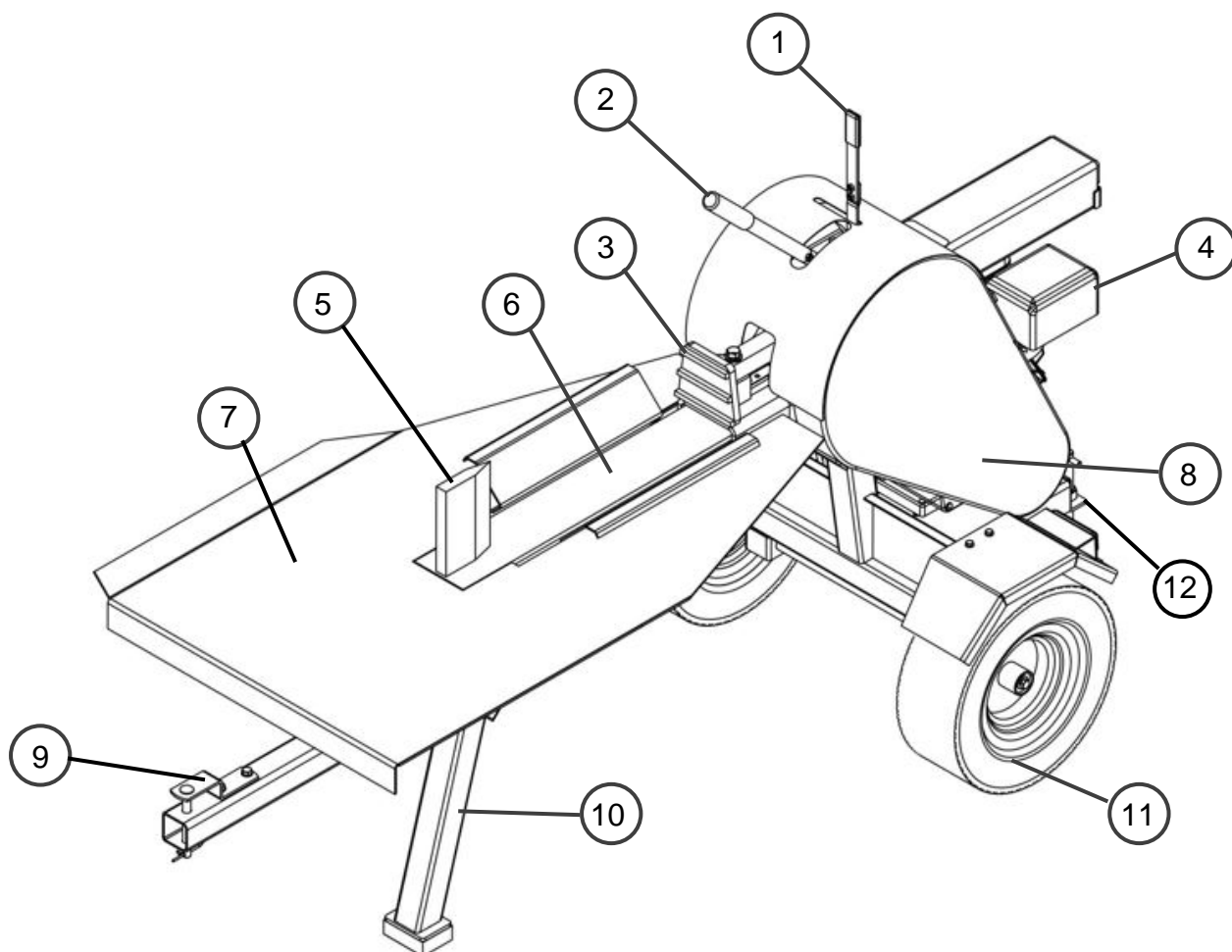

1	Safety Handle	7	Log Cradle
2	Control Handle	8	Drive Belt Cover
3	Log Pusher	9	Towing Attachment*
4	Engine	10	Front Leg
5	Splitting Wedge	11	Wheels
6	Slide Rail	12	Rear Support Leg



### NOTE

The towing attachment is for farm or forestry vehicles only.  
This log splitter **CAN NOT** be towed on public roads.

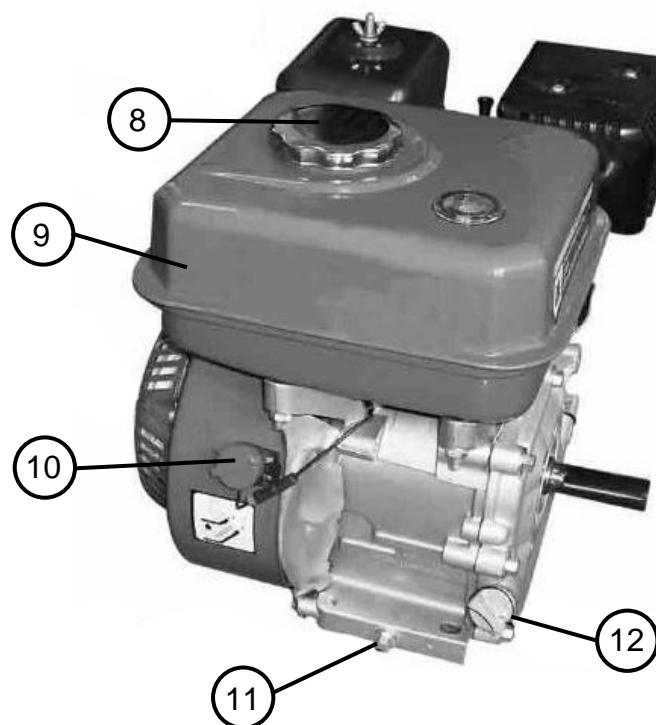
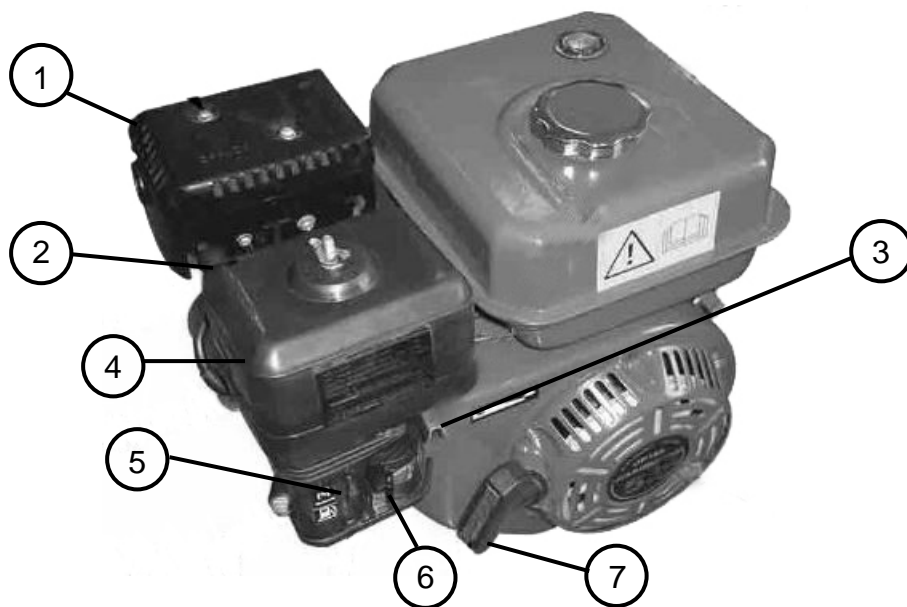

1	Exhaust	7	Recoil Starter Handle
2	Spark Plug	8	Fuel Filler Cap
3	Throttle Lever	9	Fuel Tank
4	Air Filter	10	On/Off Switch
5	Choke Lever	11	Oil Drain Plug
6	Fuel Valve	12	Oil Filler Cap

### 3. ASSEMBLY



## CAUTION

Use extreme caution when unpacking this machine. Some components are heavy and will require additional assistance or mechanical handling equipment.

- 2.0 Attach the wheels to the axles on the engine stand.
- 2.1 Place the spacer over the end of the axle and slide the wheel onto the spacer.
- 2.2 Place a spring washer then a flat washer onto the bolt making sure the flat washer faces the wheel.
- 2.3 Tighten the bolt onto the axle and secure the wheel in place.

- 1. Spacer
- 2. Flat Washer
- 3. Spring Washer
- 4. M8x20 Bolt

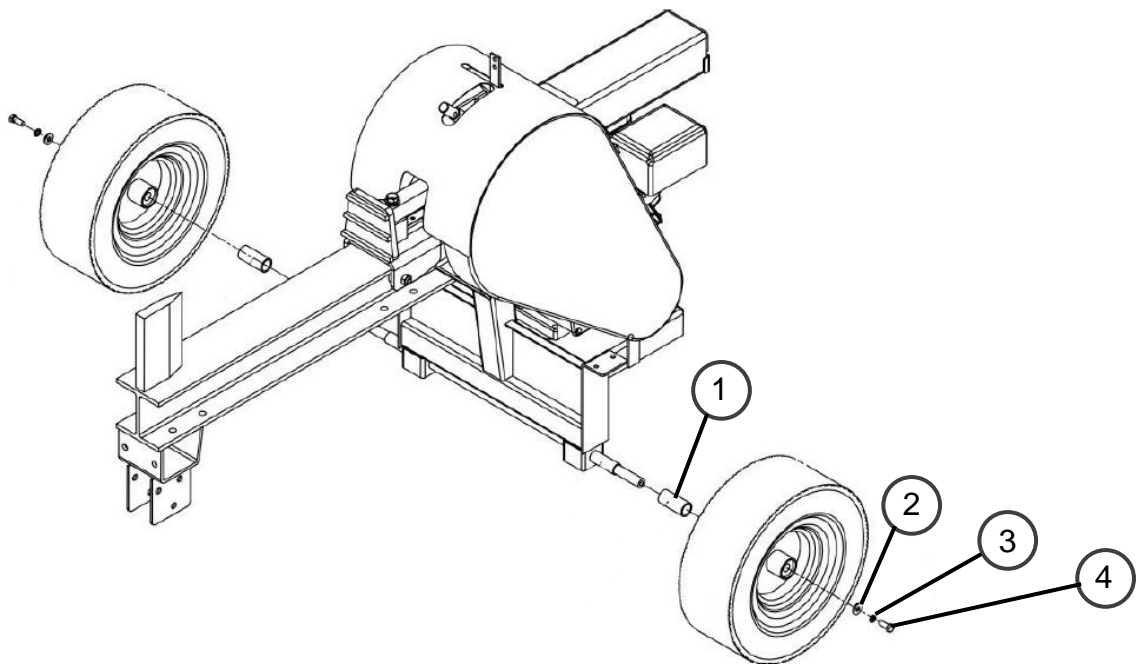

- 2.4 Attach the front support leg to the frame.
- 2.5 Slide the front support leg into the mounting bracket on the log splitter frame and make sure the holes in the support leg and the holes in the frame line up.
- 2.6 Slide an M10x75 bolt through the top mounting hole, through the support leg and out of the other side.  
Secure in place with an M10 nut but leave just enough slack for the leg to move freely.
- 2.7 Slide the locking pin through the bottom mounting hole in the frame, through the support leg and out the other side.  
Secure in place using the P clip.
- 2.8 To raise or lower the leg, remove the P clip and slide the locking pin in or out depending on whether you need to raise or lower the leg.

1. Support Leg 2. Locking Pin 3. M10x75 Bolt 4. P Clip 5. M10 Nut

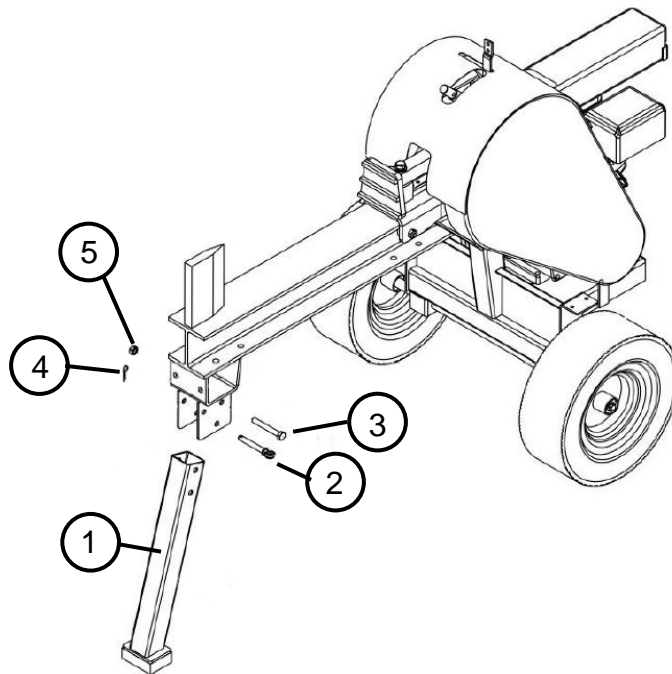

- 2.9 To fix the towing bar to the main body.
- 2.10 Line the mounting holes on the tow bar up with the holes in the log splitter frame.
- 2.11 Fix in place using the M10x25 bolts and M10 nuts.
1. M10x25 Bolt
  2. M10 Nut

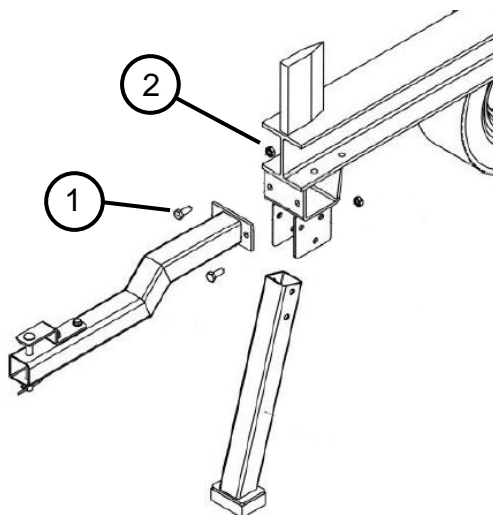

- 2.12 Attach the log support to the main body using the mounting holes in the main frame using M10x25 bolts and M10 nuts.
1. M10x25 Bolt
  2. M10 Nut

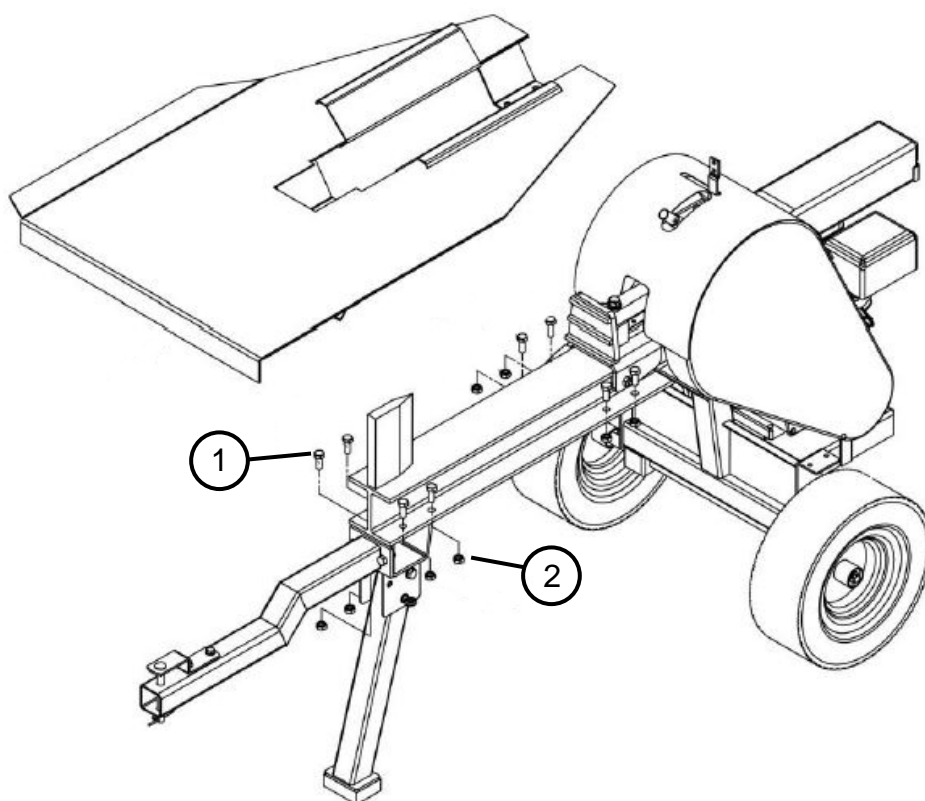

- 2.13 Attach the upper control handle to the lower control handle using an M6x30 Hex nut and an M6 nut.
- 2.14 Attach the upper safety handle to the lower safety handle using M6x16 bolts, M6 washers and M6 nuts.

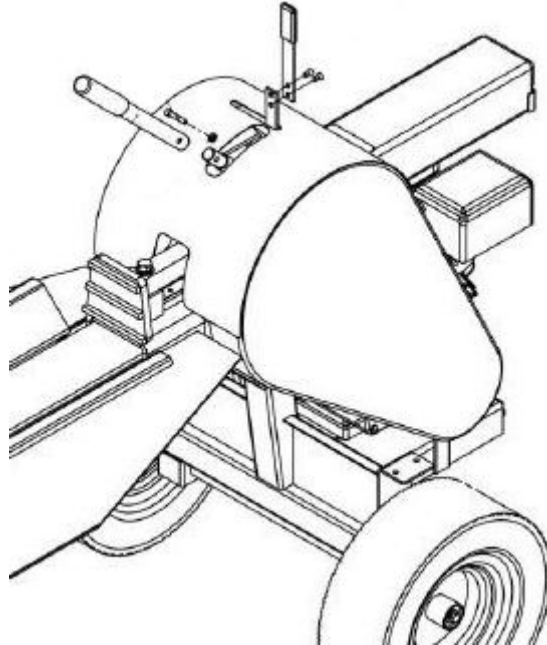

- 2.15 Attach the wheel covers to the engine stand using M6x16 bolts, M6 washers and M6 nuts.
- 2.16 Attach the rear support leg by mounting the support plate with M8x20 bolts, M8 washers and M8 nuts.

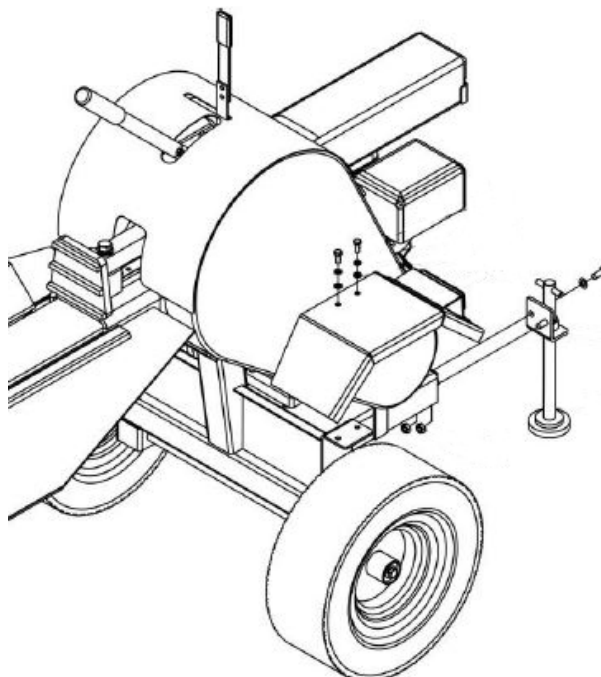

## 4. PRE OPERATION CHECKS



### CAUTION

This machine is shipped without fuel or oil.

You **MUST** fill the machine **BEFORE** use or you may cause damage to the machine that will not be covered by the warranty.



### WARNING

ALL fuel are flammable and should be handled with care.

Wipe up any spills immediately.

## ADDING OIL

- 3.0 Oil Type: Semi-Synthetic SAE 15W-40 Engine Oil.
- 3.1 Oil capacity: 500ml
- 3.2 Place the log splitter on a flat level surface.
- 3.3 Clean around the oil filler and remove the oil cap and dipstick. Wipe the dipstick clean.
- 3.4 Slowly fill the engine with oil through the oil filler until it reaches the upper thread of the filler hole or to the full mark on the dipstick.
- 3.5 Stop filling occasionally to check the oil level.  
**DO NOT OVERFILL.**
- 3.6 Refit the oil filler cap and make sure the cap is tightened.
- 3.7 You **MUST** check the engine oil level before starting every session.

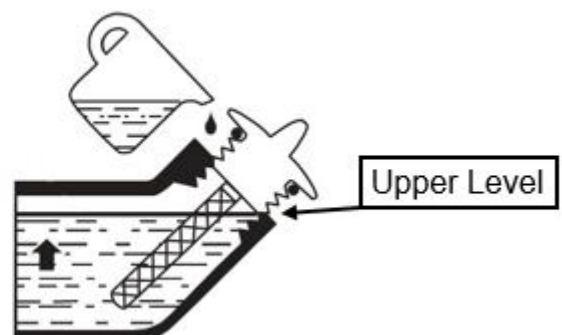



## ADDING FUEL



### CAUTION

**ALL FUELS ARE FLAMABLE**

**ALWAYS** fuel and defuel in a well ventilated area outside of buildings.

**ALWAYS** wear correct, suitable and fit for purpose Personal Protective Equipment (PPE), suggested items are but not limited to safety gloves, overalls.



### CAUTION

**DO NOT** overfill the fuel tank, you **MUST** allow space for fuel expansion.

If the fuel tank is overfilled, fuel can overflow onto a hot engine and cause fire and/or explosion.

If fuel does spill, wait until it evaporates before starting the engine.

Check fuel lines, tank, cap and fittings frequently for cracks or leaks. Replace as required.

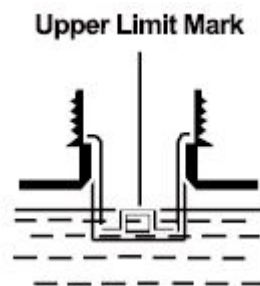

- 3.8 Fuel Type: Straight, fresh Unleaded Petrol.
- 3.9 Fuel Tank Capacity: 500ml
- 3.10 **DO NOT** light cigarettes or smoke when filling the fuel tank.  
Fuel is highly **FLAMMABLE** and its vapours are **EXPLOSIVE**.
- 3.11 **NEVER** fill the fuel tank when the engine is running or hot.  
Turn the generator **OFF** and allow the engine to cool entirely before filling the fuel tank.
- 3.12 Avoid spilling petrol onto a **HOT** engine.
- 3.13 Keep fuel away from sparks, open flames, pilot lights, heat and other sources of ignition.
- 3.14 **DO NOT** mix petrol with oil.
- 3.15 Once refuelling has finished, refit the fuel cap and fully tighten.  
Wipe up any spilt fuel before restarting the machine.

## 5. STARTING PROCEDURE



### WARNING

This machine is shipped without fuel or oil.

You **MUST** fill the machine **BEFORE** use or you may cause damage to the machine that will not be covered by the warranty.

- 4.0 Move the fuel valve lever to the **ON** position.

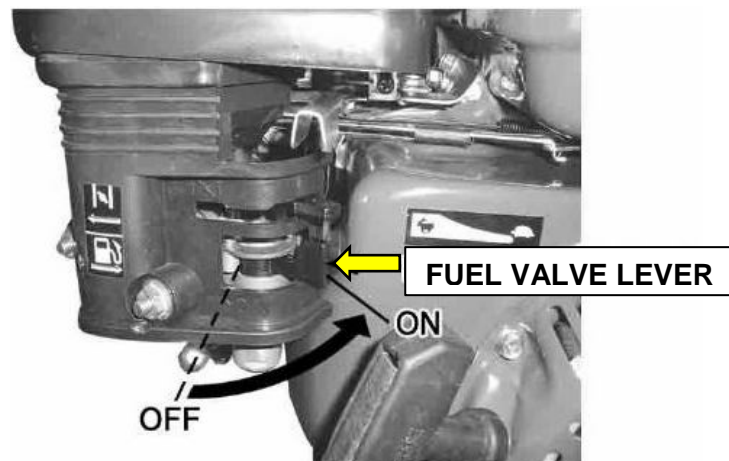

- 4.1 To start a **COLD** engine, move the choke lever to the **CLOSED** position.  
To start a **WARM** engine, leave the choke lever in the **OPEN** position.

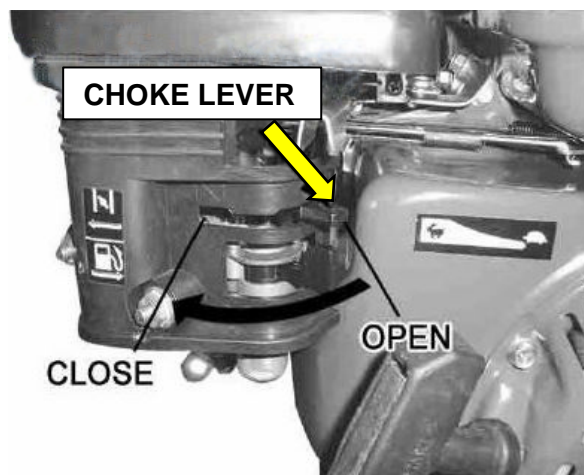

- 4.2 Move the throttle lever away from the **SLOW** position to about 1/3 of the way towards the **FAST** position.

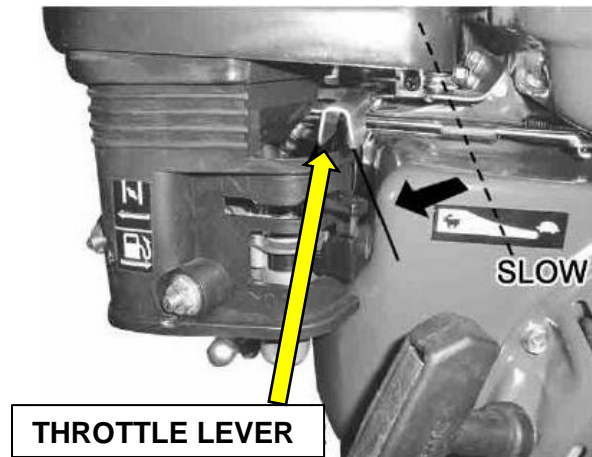

- 4.3 Turn the engine switch to the **ON** position.

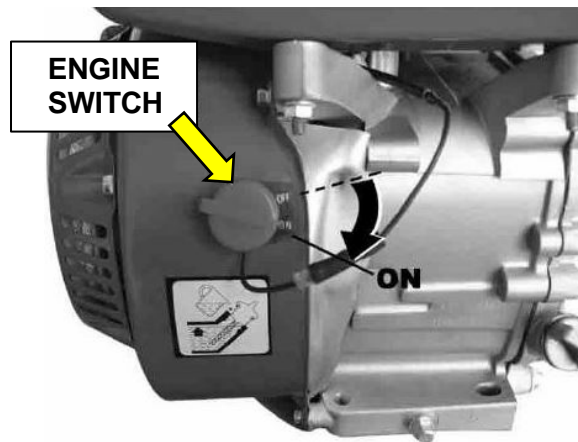

- 4.4 Gently pull the recoil starter handle until you feel resistance, then pull swiftly until the engine starts.

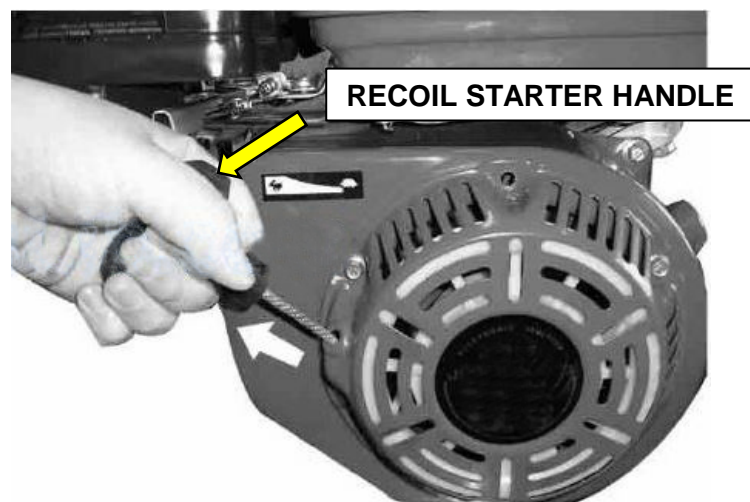

- 4.5 As the engine warms up from cold, gradually move the choke lever to the open position. If starting a warm engine, leave the choke in the open position.

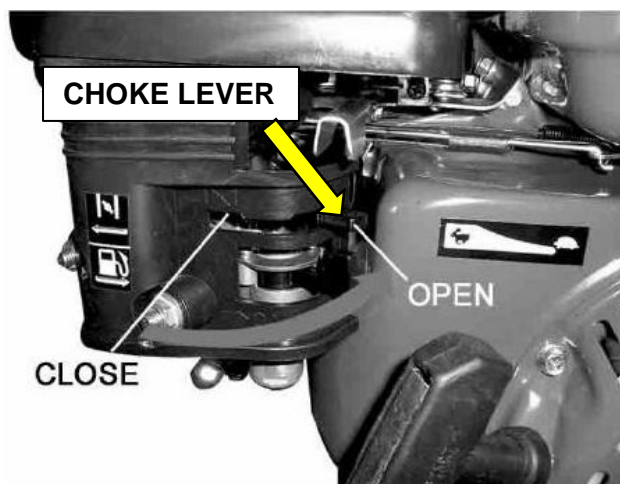

- 4.6 Set the throttle lever to the desired engine speed.

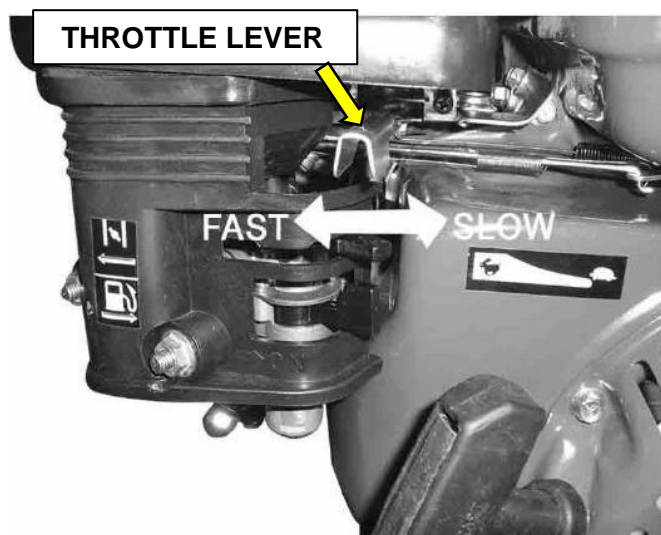

## 6. STOPPING PROCEDURE



### CAUTION

To stop the engine in an emergency, turn the engine switch to the **OFF** position. Under normal operation, use the procedure below.

- 5.0 Move the throttle lever to the **SLOW** position and allow the engine to idle with no load for 20 to 30 seconds.

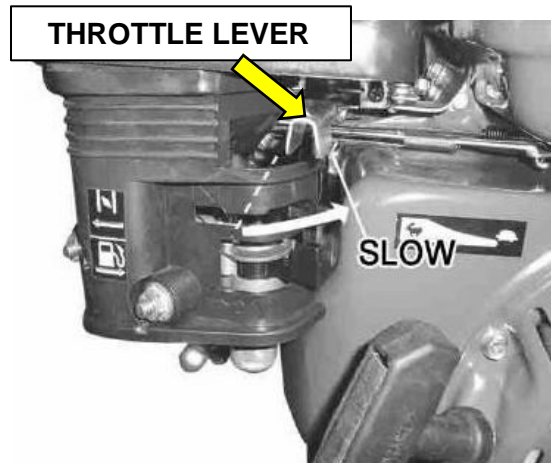

- 5.1 Turn the engine switch to the **OFF** position.

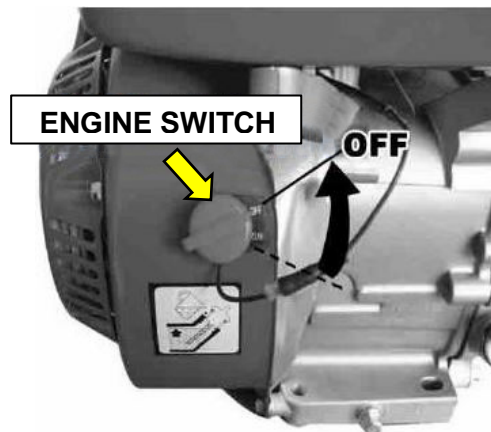

- 5.2 Turn the fuel valve lever to the **OFF** position.

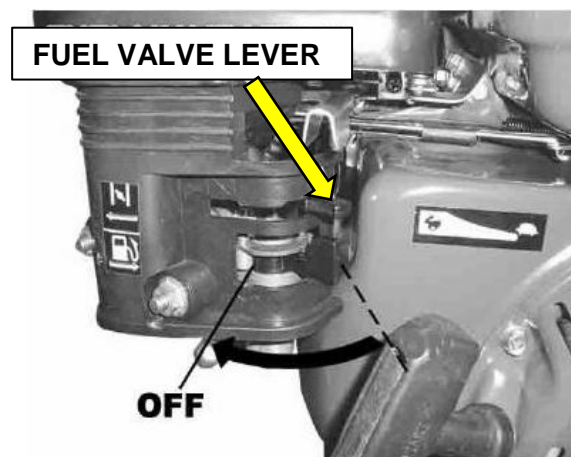

## 7. OPERATING INSTRUCTIONS



### CAUTION

**ALWAYS** keep hands and feet clear of moving parts and **NEVER** use the machine if any of the safety guards are damaged or missing.



### CAUTION

The log splitter should be kept in a horizontal position when in use.

**ALWAYS** use the rear support leg when in use.



### CAUTION

This log splitter is intended and designed only to split wood.

**NEVER** use for any other purposes as this could lead to personal injury and void the warranty.



### NOTE

**MAXIMUM LOG LENGTH – 52cm**

**LOG DIAMETER – 5 to 40cm**

- 6.0 The log splitter should be kept in a horizontal position when in use.
- 6.1 **ALWAYS** use the rear adjustable support leg when in use.
- 6.2 Lubricate the beam area where the splitting wedge will slide with a small amount of engine oil. **DO NOT** use grease.
- 6.3 The log splitter is equipped with a control system that requires the machine to be operated by both hands.
- 6.4 One hand will need to depress the safety handle while the other hand operates the control handle.  
This system keeps both hands clear of moving parts for safe operation.
- 6.5 The log splitter will stop working if either hand is removed.
- 6.6 Release the control lever to allow the log pusher to return to the start position.
- 6.7 **DO NOT** continue to apply pressure once the log has been split, this causes unnecessary stress on the rack teeth.
- 6.8 **DO NOT** place your hands on the ends of the log when loading.  
This is an unsafe method and could result in personal injury.
- 6.9 **DO NOT** reach or step across the rail while the log splitter is running.
- 6.10 **NEVER** attempt to split wood across the grain.  
The log splitter was not designed for cross-grain log splitting and doing so could damage.
- 6.11 Make sure both ends of the logs you are splitting are as square as possible.  
This will prevent the log from slipping out of position while under pressure.
- 6.12 **DO NOT** try and catch the split wood, allow it to fall to the ground.
- 6.13 **DO NOT** attempt to split 2 logs at the same time. One of them may fly up and hit you.

- 6.14 If the ram stops before the log has been split, quickly pull the control lever backwards to prevent stress on the belts.  
Once the ram is free continue to split the log.
- 6.15 If a log becomes jammed, release the controls and return the ram to the start position.
- 6.16 Insert a wedge under the jammed log, start the log splitter to push the wedge under the jammed log.
- 6.17 Repeat above procedure with a sharper slope wedge until the log is completely free.
- 6.18 **DO NOT** hit a jammed log with a hammer to try and remove as this may cause damage to the machine.

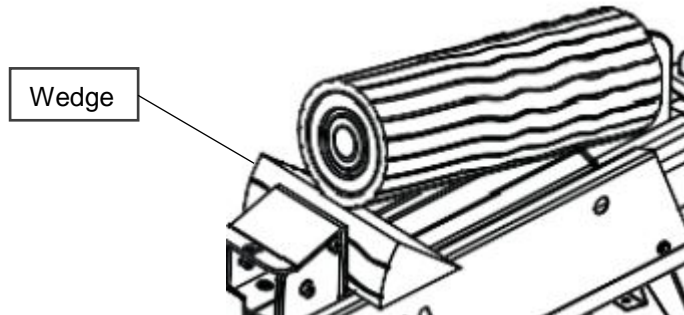

- 6.19 **ALWAYS** keep the guards in place and do not use if a guard is damaged or missing.
- 6.20 **NEVER** force or push the log when splitting.
- 6.21 **ALWAYS** wear the appropriate Personal Protective Equipment (PPE) when using the log splitter.
- 6.22 **NEVER** allow one person to operate the machine while another person loads a log.
- 6.23 **NEVER** attempt to load the log splitter while the ram is in motion.



## 8. MAINTENANCE



### WARNING

Before performing any maintenance procedure or inspection, stop the engine and allow to cool for 30 minutes.

**ALWAYS** work in a well ventilated area away from any sources of ignition.

**ALWAYS** wear the appropriate Personal Protective Equipment (PPE) when carrying out any maintenance.



### CAUTION

All maintenance and repair work must be carried out by a qualified technician.

Procedure		Before Each Use	First Month or 20 Hours	Every 3 Months or 50 Hours	Every 6 Months or 100 Hours	Every 12 Months or 300 Hours
Engine Oil	Check	X				
	Replace		X		X	
Gear Oil	Check	X				
	Replace		X		X	
Air Filter	Check	X				
	Clean			X*		
	Replace					X
Sediment Cup	Clean				X	
Spark Plug	Check				X	
	Replace					X
Grease Rack & Pinion			X			
Check Tyre Pressure				X		
Clean Engine Exterior & Cooling				X		
Change Engine Oil		1 <sup>st</sup> Time 5 Hours		X		
Replace Air Filter				X		
Replace Spark Plug					X	

\* More frequently in dusty environments.

## LUBRICATION

- 7.0 All bearings on your splitter are sealed units and should have sufficient lubricant to last the life of your machine under normal use.
- 7.1 No lubrication is required between the carriage bearing and the frame. This area must be kept free of lubricant to ensure proper operation of the splitter.

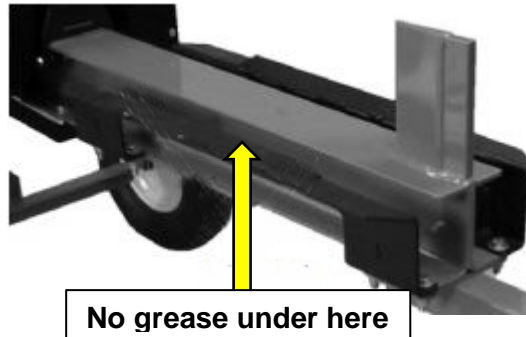

- 7.2 To grease the rack and pinion, carefully tie a piece of string on to the end loop of the return spring.
- 7.3 Remove the spring from the locknuts and hold the string as you let the spring retract back under the belt guard.  
Repeat for the spring on the other side of the frame.
- 7.4 Pull the carriage assembly out until it is near the wedge.

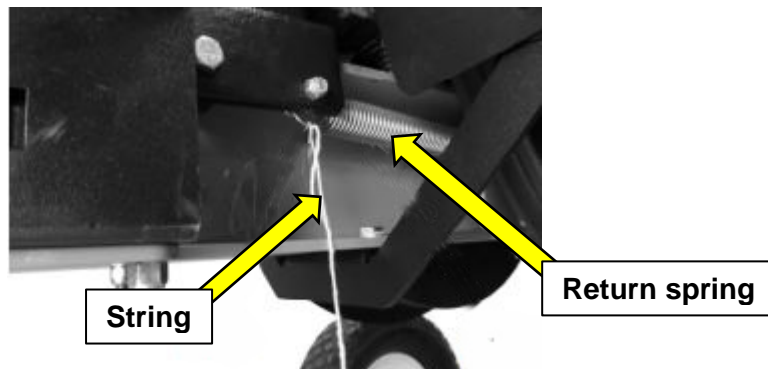

- 7.5 Grease the rack teeth with All Purpose Grease.
- 7.6 Push the carriage assembly back into the starting position, reconnect the return springs and remove the string.

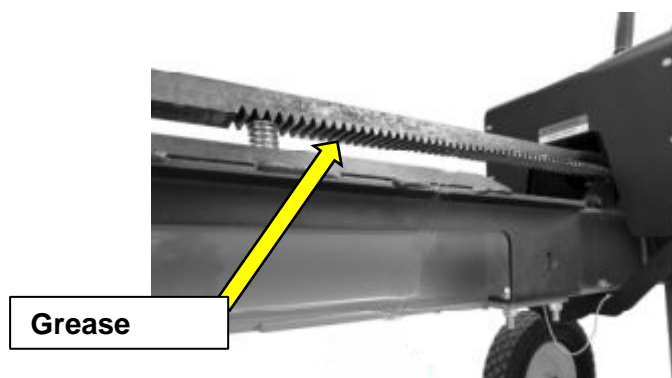

## OIL



### NOTE

**Recommended Oil:** Semi-Synthetic SAE15W40 Engine Oil.



### NOTE

Drain the engine oil when the engine is **WARM**, not **HOT**.  
Warm oil drains quickly and completely.

- 7.7 Place a suitable container underneath the oil drain plug to catch the engine oil.
- 7.8 Remove the oil filler cap/dipstick and then remove the oil drain plug.

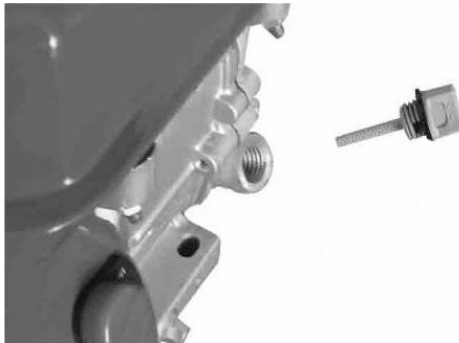

- 7.9 Allow the engine oil to drain completely.
- 7.10 Reinstall the oil drain plug and tighten securely.
- 7.11 With the engine in a level position, fill slowly with semi-synthetic SAE15W40 Engine oil to the upper level as indicated below.  
Stop occasionally to check the oil level. **DO NOT** overfill.

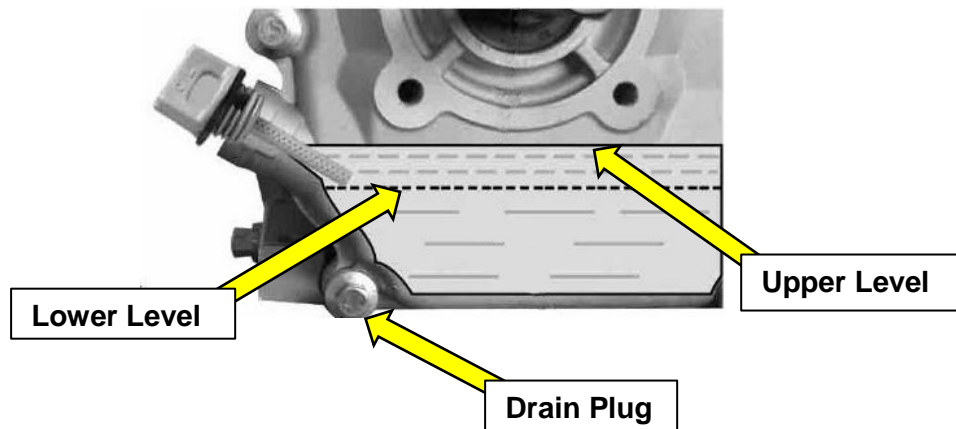

## THE SPARK PLUG

- 7.12 You **MUST** allow the spark plug to cool down before carrying out any maintenance.
- 7.13 Always replace with the same model spark plug as fitted.
- 7.14 To check spark plug, remove spark plug cap and remove spark plug using a spark plug wrench (not provided).

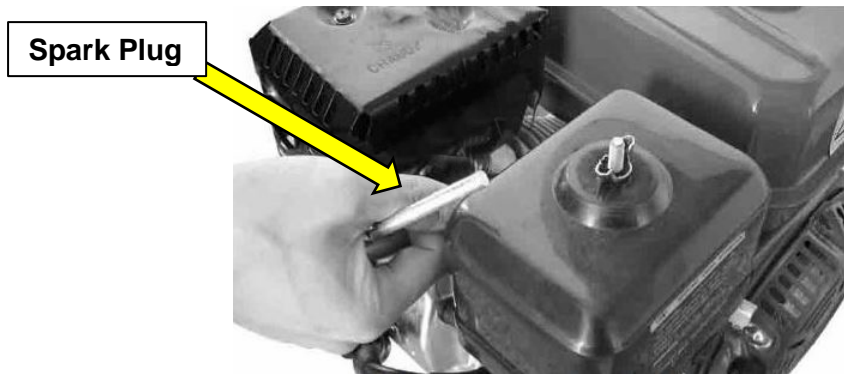

- 7.15 Clean the spark plug electrode, making sure that there is no damage to the insulator or electrode.
- 7.16 The spark plug gap should be 0.70mm to 0.80mm adjust as necessary by carefully bending the side electrode.

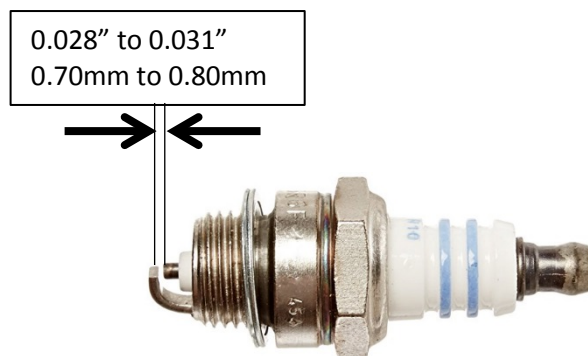

- 7.17 Refit the cleaned and adjusted spark plug by hand to avoid cross-threading.
- 7.18 After spark plug seats then tighten as necessary but avoid over-tightening.
- 7.19 Re-attach the spark plug cap.

## AIR FILTER



### CAUTION

A dirty air filter will restrict the air flow to the carburetor, which will reduce engine efficiency.

When using the lawnmower in very dusty areas you must clean or replace the air filter more often.

Never operate machine without the air filter being fitted it can cause damage to the engine, which is not covered by warranty.

- 7.20 Undo the wing nut on the top of the air filter housing and remove the air filter cover.
- 7.21 Remove the foam air filter and wash in a warm soap solution.
- 7.22 Allow the air filter to dry.
- 7.23 Remove any dust or debris from inside the air filter housing ensuring that nothing is allowed to fall into the carburetor body as this may cause damage to the engine.
- 7.24 Once the air filter is dry, soak in fresh engine oil and remove any excess.
- 7.25 Reinstall the air filter in the reverse of the procedure above.





### CAUTION

**ALL FUELS ARE FLAMABLE**

**ALWAYS** fuel and defuel in a well ventilated area outside of buildings.

**ALWAYS** wear correct, suitable and fit for purpose Personal Protective Equipment (PPE), suggested items are but not limited to safety gloves, overalls.

- 7.26 The use of old or stale fuel will impair starting and running of the machine.
- 7.27 Make sure that the machine has fresh unleaded fuel and always remove fuel before storing for long periods.
- 7.28 Never mix fuel and oil.
- 7.29 To drain the carburetor float bowl turn the fuel valve to the **OFF** position.
- 7.30 Undo the drain bolt making sure that the washer is not lost.
- 7.30 Use a suitable container to catch fuel. Take care not to spill fuel and make sure that all spilt fuel is cleared away safely.

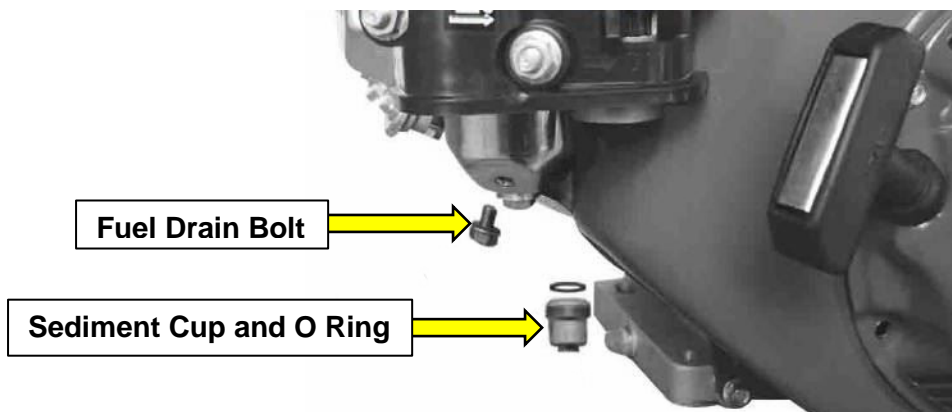

- 7.31 Once the fuel has drained, undo the sediment cup and O ring and wash thoroughly in a non-flammable solvent. Dry them thoroughly.
- 7.32 Place the O-ring in the fuel valve and install the sediment cup, tighten the sediment cup securely.
- 7.33 Reinstall the fuel drain plug and washer and tighten securely.
- 7.34 Turn the fuel valve to the **ON** position and refill with fresh unleaded petrol.

## STORAGE

- 7.35 The following steps should be taken to prepare your log splitter for storage.
- 7.36 Drain the fuel from the fuel tank, then run the machine until the engine comes to a stop. This allows the carburetor to be emptied of fuel.
- 7.37 Disconnect the HT lead and remove the spark plug.
- 7.38 Pour a teaspoon of fresh engine oil down the spark plug cylinder bore.
- 7.39 Place a clean, lint free cloth over the spark plug hole and pull the recoil starter handle a few times to allow the oil to coat the cylinder bore. Then replace the spark plug but **DO NOT** replace the HT lead.
- 7.40 Clean the splitter completely and make sure all moving parts are lubricated. **DO NOT** use a hose pipe or pressure washer to clean the log splitter as water could penetrate vital components and cause damage.
- 7.41 Check the machine to make sure that it is ready for the following season. Replace or repair as necessary.
- 7.42 Once all work above is carried out store the machine in a clean and dry place away from sources of ignition. **DO NOT** store a machine that has not been given time to fully cool down.

## 9. TRANSPORTING

- 8.0 Ensure the machine is turned off and the spark plug HT lead cap has been removed.
- 8.1 Make sure no fuel is allowed to leak during transport.
- 8.2 Secure the machine so it will not move during transport.
- 8.3 Never try to lift or carry the machine on your own. Always use assistance.



## 10. TROUBLESHOOTING

PROBLEM	POSSIBLE CAUSE	POSSIBLE SOLUTION
Engine will not start	Fuel Valve OFF	Move fuel valve lever to ON
	Choke OPEN	Move choke lever to CLOSED unless engine is warm
	Engine switch OFF	Turn engine switch to ON
	Out of fuel	Refuel
	Bad fuel; engine stored without treating or draining petrol, or refuelled with stale petrol	Drain fuel tank and carburetor. Refuel with fresh petrol
	Spark plug faulty, fouled or improperly gapped	Remove and inspect spark plug. Clean, gap or replace spark plug
	Spark plug wet with fuel (flooded engine)	Remove and inspect spark plug. Dry and reinstall spark plug. Start engine with throttle lever in FAST position
	Fuel filter clogged, carburetor malfunction, ignition malfunction, valve stuck etc.	Take engine to a qualified repair centre. Replace or repair faulty components as necessary
Engine lacks power	Filter element clogged	Check air filter. Clean or replace filter
	Bad or stale fuel	Drain fuel tank and carburetor. Refuel with fresh petrol
	Fuel filter clogged, carburetor malfunction, ignition malfunction, valves stuck etc.	Take engine to a qualified repair centre. Replace or repair faulty components as necessary
Rack catching on tail tube (at end of stroke)	Wood chips or debris caught between ram bushing plate and beam	Clean beam of built up/caked on debris
Rack returning very slowly or not returning at all	Rack lift bearing out of alignment or damaged	Re-align the bearing or replace as necessary
	Return spring unhooked or damaged	Reconnect or replace as necessary
	Machine wedge end too low	Must be almost level or wedge end slightly higher. Perform rail maintenance and lubricate the beam

## TROUBLESHOOTING CONT...

Operator lever snapping out of gear or not staying in gear	Leve not all the way forward when the rack comes under full load	Push the lever quicker and more forcefully into the forward position. A hard stop should be felt at the end of the stroke when engaging the handle.
	Stop bolt not adjusted correctly	Take to a qualified repair centre. Replace or repair faulty components as necessary
	Ram overloaded at lower part of face	Check rack gear for straightness
Rack slamming back too fast	Wedge end of machine too high	Must be almost level with ram end or just slightly higher
	Springs not operating correctly	Fix or replace as needed
Machine does not seem to have full splitting power	Belt(s) may be loose and slipping	Adjust or replace the belt(s) as necessary
Operator lever not engaging rack with pinion gear	Debris trapped underneath the rack	Clear debris from under the rack
	Accumulated dirt and debris on rubber bumpers	Clean accumulated dirt and debris from frame where carriage assembly rests against rubber bumpers
Rack not disengaging from pinion when handle is released	Belts overtight	Belts must be loosened to allow for slipping while disengaging

## 11. SPECIFICATION

Engine Displacement	6.5hp
Engine Model	Hyundai IC200
Splitting Force	15 Tonnes
Fuel	Unleaded Petrol
Oil	Semi-Synthetic SAE15W40
Max Log Length	52cm
Max Log Diameter	40cm
Travel Time	3 seconds
Working Table Height	57cm
Wedge Height	16cm
Wedge Width	2.54cm
Tire	13x5
Overall Height	101cm
Overall Length	200cm
Overall Width	73cm
Flywheel Weight	16Kg
Flywheel Diameter	30cm

## 12. RECYCLING AND PRODUCT DISPOSAL

- 9.0 We do not offer a takeback scheme for the recovery of Waste Electrical Electronic Equipment (WEEE) & Batteries.  
Instead the responsibility to dispose of WEEE and or Batteries is passed onto you by us.  
So when it becomes necessary to dispose of your machine you must take it to your local Civic Amenity Site.  
For further information please contact your local Authority for disposal advice.
- 9.1 You **MUST** make sure that all unused oil and fuel is disposed of correctly either beforehand or at your local Civic Amenity Site.  
Under NO circumstances must any fuel or oil be put down any drains.
- 9.2 Certain products contain WEEE waste which should not be disposed of in your domestic waste.
- 9.3 You **MUST** recycle WEEE in accordance with your local authority or recycling centre.
- 9.4 Certain products contain batteries which should not be disposed of in your domestic waste.
- 9.5 You **MUST** recycle batteries in accordance with your local authority or recycling centre.
- 9.6 Unwanted packaging and materials should be stored and taken to a recycling centre so it can be disposed of in a manner which is compatible with the environment.
- 9.7 The following symbol means that you should 'Reduce – Reuse – Recycle'.
- 9.8 We are a Member of the VALPAK National Compliance Scheme and our registration number is **RM08660**
- 9.9 For further information about disposal please contact your Local Authority.
- 9.10 You can also get more advice and guidance about recycling at the following website <http://www.recycle-more.co.uk>
- 9.11 Should you pass this product on to another user either sold or loaned, you **MUST** pass on this user manual.  
This will make sure that all other users can use and maintain this machine safely.

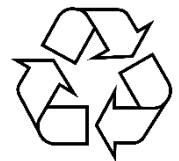
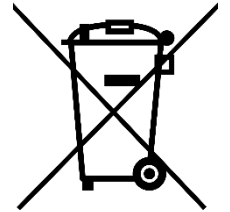

## 13. DECLARATION OF CONFORMITY

10.0 Genpower Ltd confirms that this Hyundai product conforms to the following CE Directives;

2006/42/EC Machinery Directive

2004/108/EC EMC Directive

2000/14/EC, Amended by 2005/88/EC Noise Emissions Directive

97/68/EC\_2010/26/EC NRMM Emissions Directive

### EC DECLARATION OF CONFORMITY

The undersigned. As authorised by: **Genpower Ltd**

Declares that the following equipment manufactured under licence by Hyundai Korea

Conforms to the Directive:-  
**2000/14/EC (as amended)**

Of the European Parliament and of the council on the approximation of the laws of the Member States relating to the noise emission in the environment by equipment for the use outdoors.

Equipment Category:	<b>Power Equipment</b>
Product Name/Model:	<b>HYLS15520T</b>
Type/Serial No:	<b>Log Splitter</b>
Net installed power:	<b>6.5hp</b>
The technical documentation is kept by:	<b>Roland Llewellyn, Genpower Ltd Isaac Way, Pembroke Dock, Pembrokeshire, SA72 4RW.</b>

The conformity assessment procedure followed was in accordance with annex V of the Directive.

Notified Body:	<b>Istituto Giordano, Via Gioacchino Rossini 2 – 47814 Bellaria-Igea Marina (RM) Italy Certification n° 75406/2116/Crev.1</b>
----------------	---

Measured Sound Power Level:	<b>112dB</b>
-----------------------------	--------------

Guaranteed Sound Power Level:	<b>112dB</b>
-------------------------------	--------------

A copy of this certificate has been submitted to the European Commission and the EU Member State United Kingdom.

Place of Declaration:	<b>Pembroke Dock, SA73 4RW</b>
-----------------------	--------------------------------

Date:	<b>08/05/2018</b>
-------	-------------------

Signed by:	<b>Roland Llewellyn</b>
------------	-------------------------



Position in Company:	<b>Managing Director</b>
----------------------	--------------------------

Name and address of manufacturer or Authorised representative:

**Genpower Ltd  
Isaac Way, Pembroke Dock,  
Pembrokeshire, SA72 4RW**

## 14. CONTACT DETAILS

11.0	POSTAL ADDRESS	Genpower Ltd, Isaac Way, London Road, Pembroke Dock, Pembrokeshire. SA72 4RW. UK.
11.1	TELEPHONE	+44 (0) 1646 687880
11.2	FAX	+44 (0) 0164 686198
11.3	TECHNICAL EMAIL	aftersales@genpower.co.uk
11.4	WEBSITE	www.hyundaipowerequipment.co.uk

## 15 WARRANTY

- 12.0 To register your machine for the manufacturer's warranty, please visit  
<https://www.hyundaipowerequipment.co.uk/warranty>

## 16. MANUAL UPDATES

- 13.1 Our manuals are constantly being reviewed and updated.  
However if you find an error, omission or something you find unclear, please  
contact your dealer for assistance.
- 13.2 Our latest manuals are also placed online.
- 13.3 We reserve the right to make any modifications without prior notice whenever  
necessary.



**For Inquiries, Please Contact:**

**GENPOWER LTD**

Isaac Way, London Road

Pembroke Dock, UNITED KINGDOM, SA72 4RW

T: +44 (0) 1646 687 880 F: +44 (0) 1646 686 198

E: [info@hyundaipowerequipment.co.uk](mailto:info@hyundaipowerequipment.co.uk)

[www.hyundaipowerequipment.co.uk](http://www.hyundaipowerequipment.co.uk)