

**HYUNDAI**

# **LOG SPLITTER HYLS7410**

---

**User Manual**

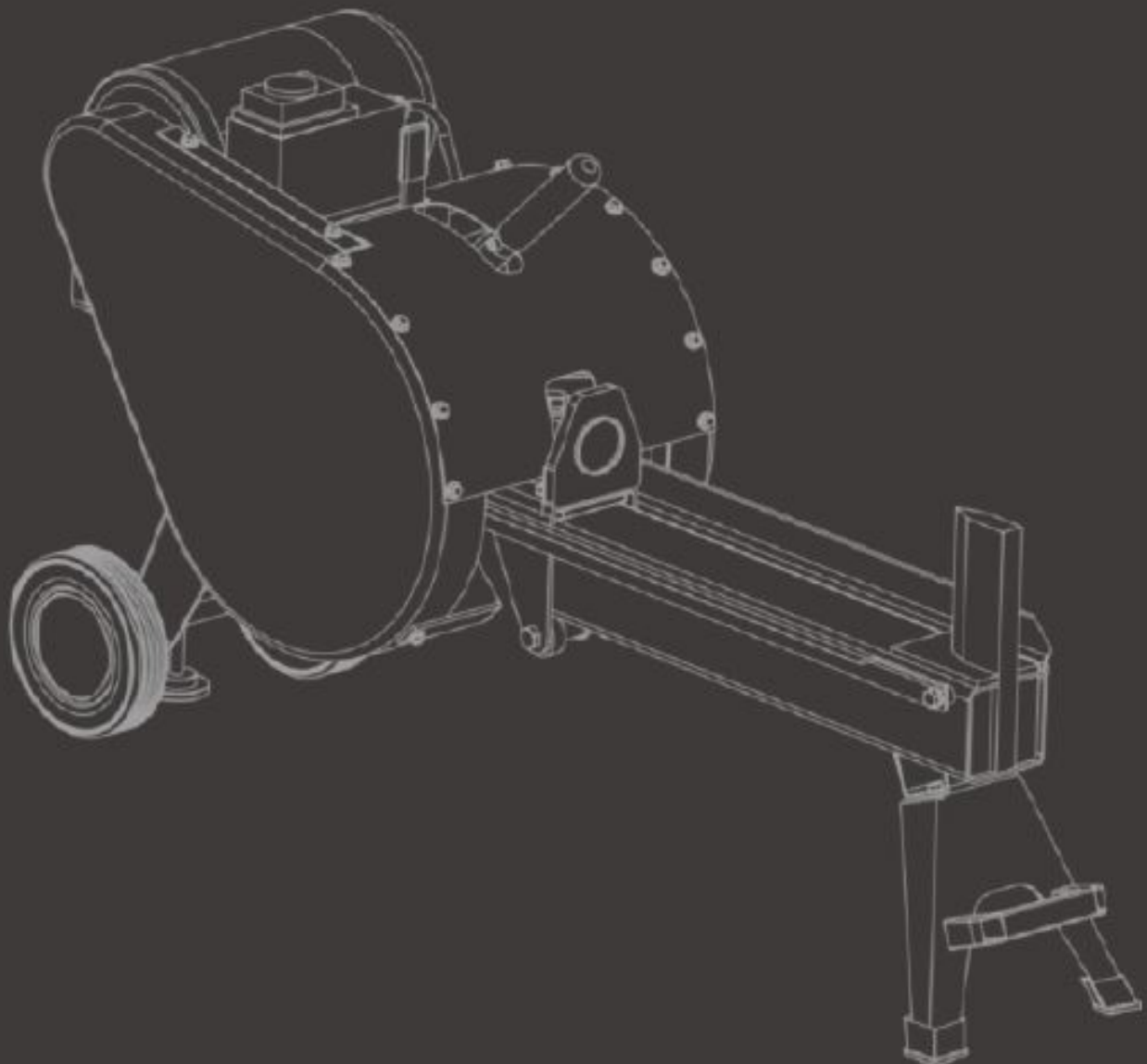

# INDEX

	<b>CONTENTS</b>	<b>PAGE NO.S</b>
1	SAFETY	3 - 8
2	PART LOCATIONS	9
3	ASSEMBLY	10 - 14
4	USING THE MACHINE	15 - 17
5	MAINTENANCE	18 - 21
6	TROUBLESHOOTING	22 - 23
7	SPECIFICATION	23
8	RECYCLING AND PRODUCT DISPOSAL	24
9	DECLARATION OF CONFORMITY	25
10	CONTACT DETAILS	26
11	WARRANTY	26
12	MANUAL UPDATES	26

# 1. SAFETY

## 1.1 General Safety Notes.

- 1.2 The operator of the machine is responsible for, and has a duty of care in making sure that the machine is operated safely and in accordance with the instructions in this user manual. Keep the manual safe and pass it on if the machine is loaned or sold to another user.
- 1.3 Please note the following safety points.
- 1.4 The machine should never be left in a condition which would allow an untrained or unauthorised person/s to operate this machine.
- 1.5 All due care and diligence should be taken by the operator for the safety of and with regard to those around whilst using the machine.
- 1.6 Some or all of the following - warning signs, symbols and/or PPE pictograms may appear throughout this manual. You **MUST** adhere to their warnings. Failure to do so may result in personal injury to yourself or those around you.



## DANGER

Indicates a hazard, which, if not avoided, could result in serious injury or death.



## WARNING

Indicates a hazard, which, if not avoided, could result in serious injury.



## CAUTION

Indicates a hazard which, if not avoided, might result in minor or moderate injury.



## NOTE

Indicates a situation that could easily result in equipment damage.

READ and keep the manual safe and pass it on if the machine is loaned or sold to another user.

You **MUST** fully understand all instructions to ensure you use and operate the machine safely.

Appropriate Personal Protective Equipment (PPE), **MUST** be worn at all times when operating or repairing the machine.



HAND  
PROTECTION  
MUST BE WORN



EYE  
PROTECTION  
MUST BE WORN



PROTECTIVE  
CLOTHING  
MUST BE WORN



HEARING  
PROTECTION  
MUST BE WORN



FOOT  
PROTECTION  
MUST BE WORN



HEAD  
PROTECTION  
MUST BE WORN



RESPIRATOR  
MUST BE WORN



FACE SHIELD  
MUST BE WORN

1.10 Carbon Monoxide (where applicable).

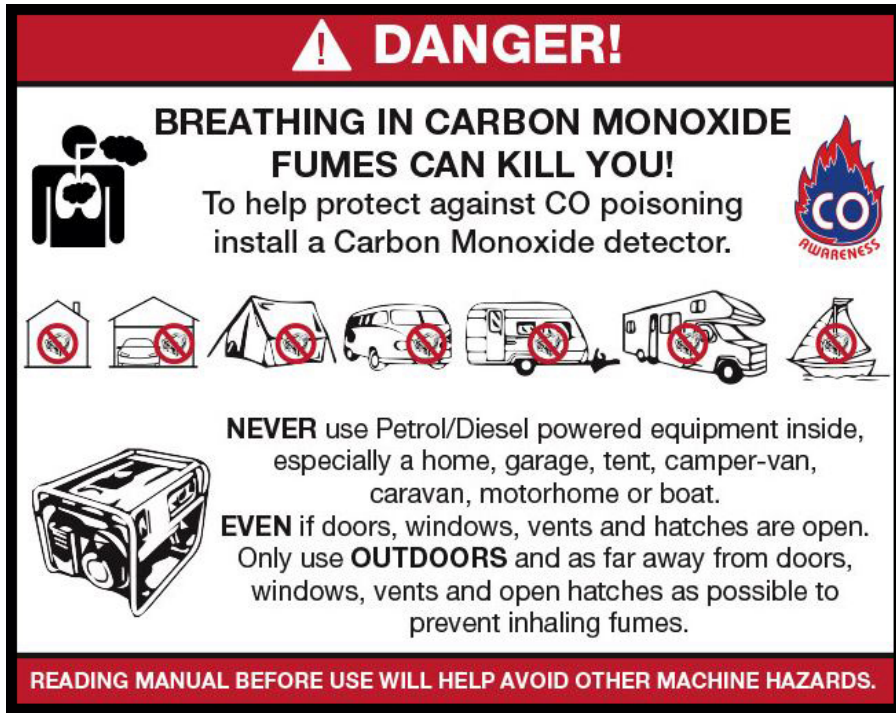

- 1.11 Carbon monoxide is a colourless and odourless gas. Inhaling this gas can cause death as well as serious long term health problems such as brain damage.
- 1.12 The symptoms of carbon monoxide poisoning can include but are not limited to the following;  
Headaches, dizziness, nausea, breathlessness, collapsing or loss of consciousness.
- 1.13 Carbon monoxide poisoning symptoms are similar to flue, food poisoning, viral infections and simply tiredness. It is quite common for people to mistake this very dangerous poisoning for something else.
- 1.14 To avoid carbon monoxide poisoning **DO NOT** use Petrol/Diesel powered equipment inside any of the following; Home, garage, tent, camper van, mobile home, caravan or boat. This is not exhaustive and if you are in any doubt contact your dealer.
- 1.15 If you think you have or someone around you has been affected by carbon monoxide poisoning;
- 1.16 Get them fresh air immediately, by leaving the affected area or by opening doors and windows. If safe and practical to do so make sure that the machine is turned off. **DO NOT** enter a room you suspect of having carbon monoxide present – instead call the emergency services.
- 1.17 Contact a Doctor immediately or go to Hospital – let them know that you suspect carbon monoxide poisoning.
- 1.18 **DO NOT** use in an enclosed area or moving vehicle.

1.20 **General Fuel Safety (where applicable).**



## **CAUTION**

### **ALL FUELS ARE FLAMABLE**

1.21 Fire Hazard – keep fuel away from all sources of ignition for example heaters. Lamps, sparks from grinding or welding.



1.22 **DO NOT** carry out hot work on tanks that have contained fuel.

1.23 **ALWAYS** keep the work area tidy.

1.24 **ALWAYS** clean up spills promptly using absorbent granules and a lidded bin.

1.25 **ALWAYS** dispose of waste fuels correctly.

1.30 **Fueling/De-fueling (where applicable).**



## **CAUTION**

### **ALL FUELS ARE FLAMABLE**

1.31 **ALWAYS** fuel and defuel in a well ventilated area outside of buildings.

1.32 **ALWAYS** wear correct, suitable and fit for purpose Personal Protective Equipment (PPE), suggested items are but not limited to safety gloves, overalls.



1.33 When fueling/de-fueling **ALWAYS** avoid inhaling fumes.

1.34 When de-fueling **ALWAYS** use a proper fuel retriever.



1.35 **ALWAYS** carry fuel in the correct and clearly marked container.

1.40 **Electrical Safety (where applicable).**

1.41 Electricity can kill – **NEVER** work on **LIVE/ENERGISED** equipment.

1.42 Prior to carrying out any maintenance work you **MUST** identify electrical isolation methods and isolate all electrical supplies.

1.43 Prior to use and with all electrical supplies isolated, you **MUST** check all electrical cables, plugs and connectors for the following;

1.44 Are intact and have no signs of damage, to include but not limited to bare wires, chaffing, cuts and loose wiring.

1.45 If there are any signs of damage, the damaged item **MUST** be taken out of service until the damage has been repaired by an electrically competent person.

1.46 All trailing cables should be routed so as not to cause any kind of trip hazard.

1.47  **NEVER** work on or near electricity with wet hands, wet clothing and wet gloves.



### 1.50 Batteries (where present).

1.51 Batteries present a risk if they become damaged by the possible leaking of electrolyte. This electrolyte is an acid and can cause serious burn injuries. Care should be taken when working on or near them. **NOTE** the electrolyte may be in a liquid or gel form.

1.52 Should you come in to contact with electrolyte you should;

1.53 Remove all clothing contaminated with electrolyte. If you cannot remove then saturate them in water.

1.54 Get medical assistance as soon as possible. You must advise the medical staff of the type of acid.

1.55 Lead/acid battery = dilute sulphuric acid.

1.56 Nickel/cadmium = potassium hydroxide alkali electrolyte.

1.57 Use fresh running water to wash off excess electrolyte, continue this until medical assistance arrives. Make sure that you do not wash the electrolyte to another part of your body or face.

1.58 If electrolyte comes in to contact with Eyes the electrolyte needs to be immediately washed away with large amounts of water. Make sure that you do not wash the electrolyte to another part of your face or body.

1.59 Gasses from charging batteries are highly flammable and great care should be taken to charge in well ventilated areas.

1.59.1  There is an explosion risk if the battery terminals are short circuited, when connecting/disconnecting **ALWAYS** exercise great care so that the terminals or battery leads are **NOT** allowed to touch and cause a spark. **ALWAYS** use suitable insulated tools.



### 1.60 Vibrations (where applicable).

1.61 Prolonged use of hand held (operated) machines will cause the user to feel the effects of/from vibrations. These vibrations can lead to white finger (Raynaud's phenomenon) or carpal tunnel syndrome. This condition reduces the ability of the hand to feel and regulate temperature, causing numbness and heat sensations and may cause never damage and circulatory tissue death.

1.62 Not all factors that lead to white finger disease are known, but cold weather, smoking and other diseases that affect blood vessels and blood circulation as well as large and long-lasting impact of shocks are considered factors in the formation of white finger. Note the following to reduce the risk of white finger and carpal tunnel syndrome;

1.63 Wear gloves and keep your hands warm.

1.64 Take regular breaks.

1.65 All of the above precautions may help reduce the risk of white finger disease but not rule out the carpal tunnel syndrome. Long-term and regular users are therefore

recommended to observe the condition of your hands and fingers. Seek medical attention immediately if any of the above symptoms should occur.

## 1.70 Noise (where applicable).

1.71 The operating noise of the machine can damage your hearing. Wear hearing protection such as earplugs or ear defenders to protect your hearing. Long-term and regular users are advised to have hearing checked regularly. Be especially vigilant and cautious when hearing ear protection because your ability to hear alarm warnings will be reduced.

1.72 Noise emissions for this equipment is unavoidable. Carry out noisy work at approved times and for certain periods. Limit the working time to a minimum. For your personal protection and protection of people working nearby it is also advisable for them to wear hearing protection.

1.73 See Certificate of Conformity section for Outdoor Noise declaration of conformity.



## MACHINE SPECIFIC SAFETY

### 1.80 General Machine Safety.

1.81 Read the owner's manual carefully to understand how to operate this machine properly.

1.82 You should **NEVER** use the machine when;

1.83 Wearing loose clothing, barefoot or sandals.

1.84 Under the influence of drink or drugs or as a result of having taken medication for cold or flu, or any other times when a possibility exists that your judgement might be impaired or that you might not be able to operate the machine properly and in a safe manner.

1.85 Suffering from exhaustion or lack of sleep.

1.86 When the ground is slippery or when other conditions exist which might make it not possible to maintain a steady posture.

1.87 At night, at times of heavy fog, or at any other times when your field of vision might be limited and it would be difficult to gain a clear view of the area.

1.88 During rain storms, lightning storms, at times of strong or gale force winds, or at any other times when the weather conditions might make it unsafe to use this product.

1.89 **NEVER** run the engine indoors. The exhaust gasses contain harmful carbon monoxide.

1.90 When using this machine for the first time and before actual work, you **MUST** learn how to handle the machine from an experienced or skilled person.

1.91 Limit the amount of time using the machine continuously to somewhere around 10 minutes per session and take 10 to 20 minutes of rest between sessions. Also try to keep the total amount of work in a single day limited to 2 hours or less.



- 1.92 **NEVER** allow children or anyone unable to fully understand the directions given in this manual to operate this product.
- 1.93 Make sure you keep this manual handy so you may refer to it whenever questions arise and ensure you pass this manual on if the machine is loaned or sold.
- 1.94 Correct Personal Protective Equipment (PPE) **MUST** be worn at all times when operating or repairing this machine. This should include but is not limited to;



- 1.95 **NEVER** open the switch box or motor cover.
- 1.96 **NEVER** use an extension cable that is not rated for outdoor use.
- 1.97 Extension cables up to 8 meters must be no smaller than 12AWG.  
Extension cables up to 15 meters must be no smaller than 10AWG.
- 1.98 **NEVER** operate the log splitter in damp or wet conditions.
- 1.99 **NEVER** operate the log splitter with a damaged plug, cable or extension cable.
- 1.99.1 **NEVER** tamper with safety devices and check their operation frequently.
- 1.99.2 **ALWAYS** grasp the plug when unplugging, DO NOT unplug by pulling the cord.



## 2. PART LOCATIONS

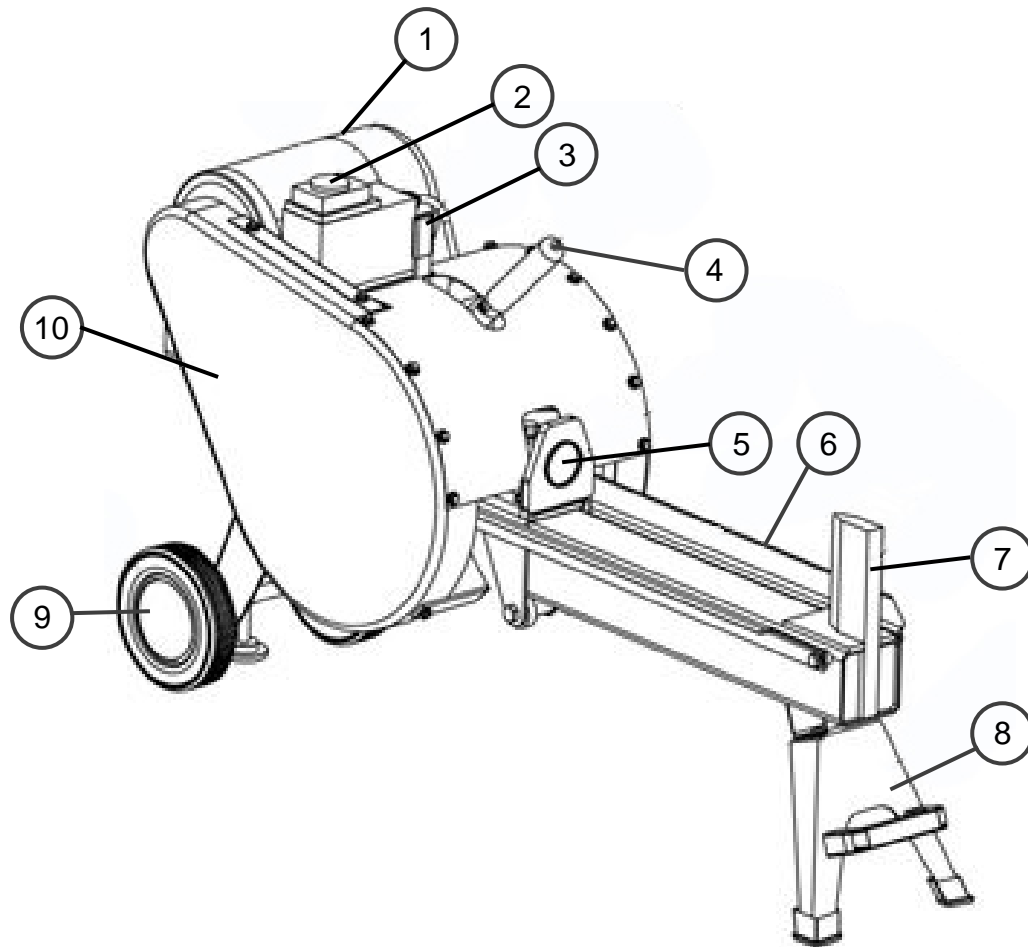

1	Electric Motor	6	Log Cradle/Rail
2	On/Off Switch	7	Splitting Wedge
3	Safety Handle	8	Front Support Leg
4	Control Handle	9	Wheels
5	Log Pusher	10	Belt Guard

### 3. ASSEMBLY



## CAUTION

Use extreme caution when unpacking this machine. Some components are heavy and will require additional assistance or mechanical handling equipment.

- 2.0 Attach the front support leg to the log cradle using the nuts and bolts provided.

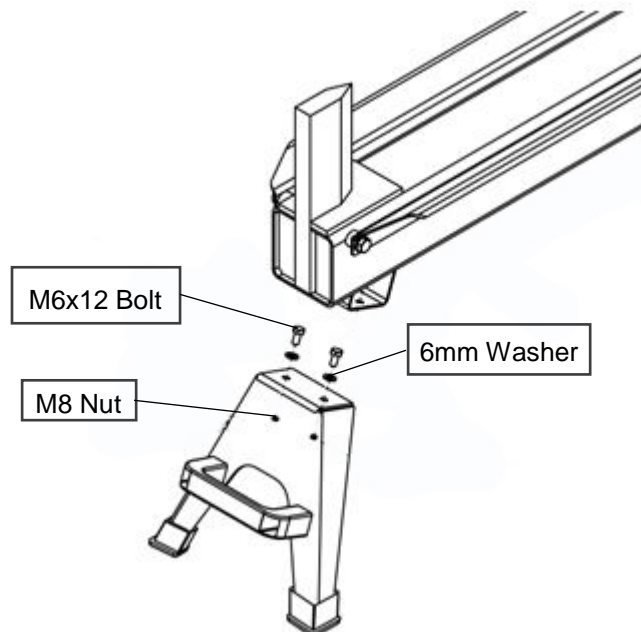

- 2.1 Attach the wheels to the frame and secure using the lock washers provided.

- 2.2 Place the wheel cover over the wheel.

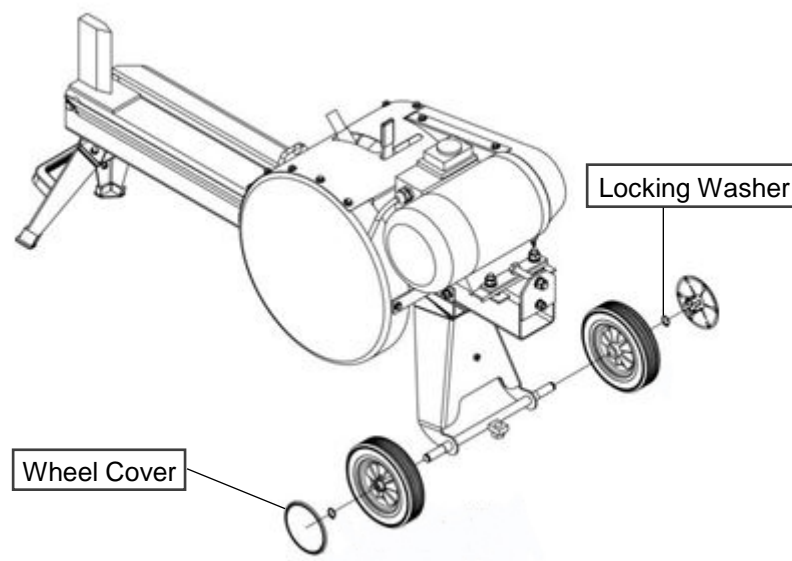

2.3 Attach the top of the control handle to the base.

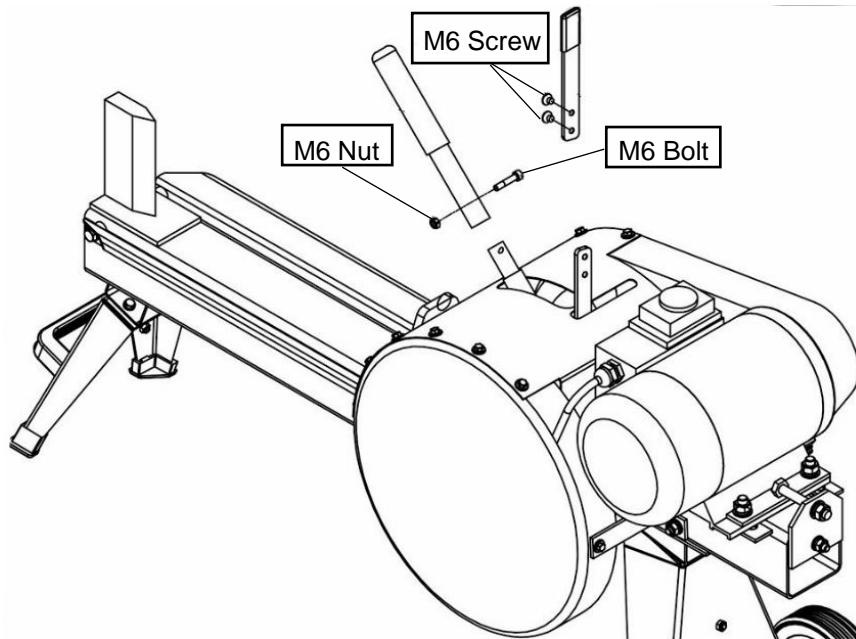

2.4 Assemble the rear adjustable support leg.

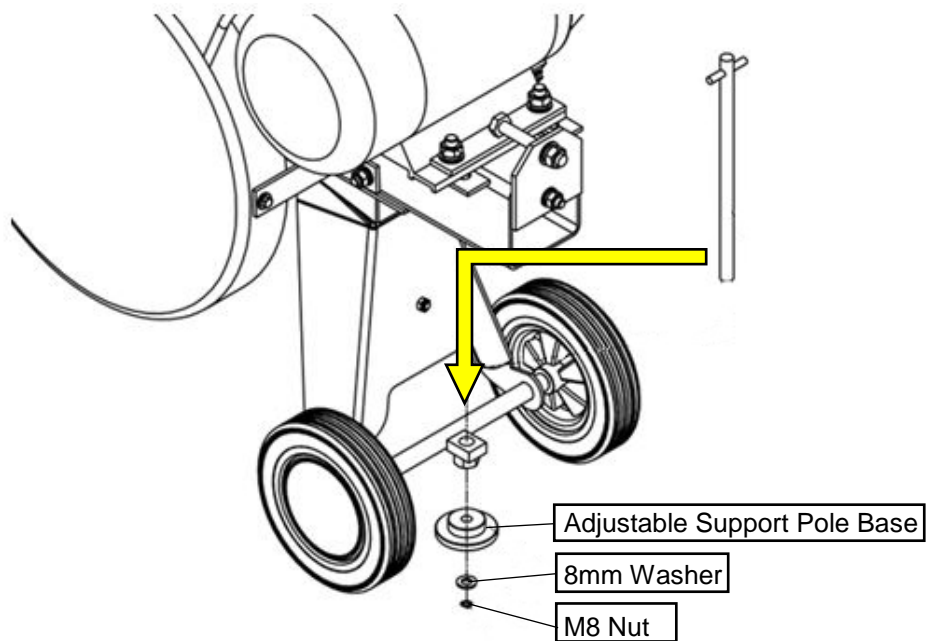

## OPTIONAL LOG TRAY & TALLER STAND



### NOTE

The log tray and taller stand are optional and are **NOT** included. These are purchased separately.

## STAND ASSEMBLY

- 2.5 Attach the wheels to the axle on the frame.

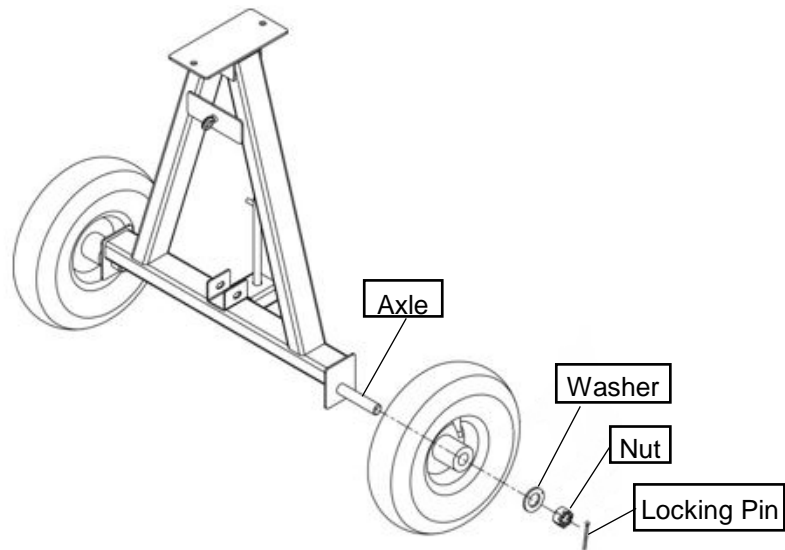

- 2.6 Attach the front leg to the main centre support bar, then attach to the wheel assembly using the nuts and bolts provided.

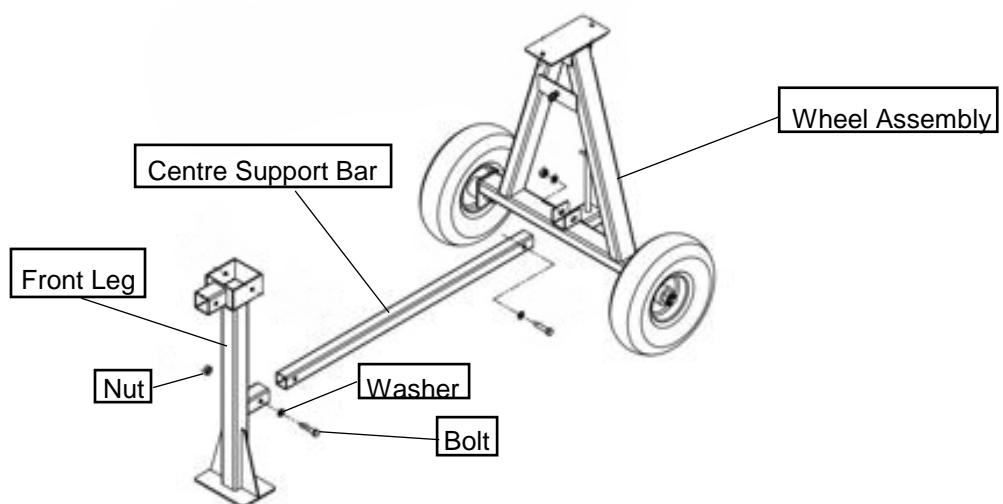

- 2.7 Mount the log splitter to the mounting points on the assembled frame.  
**NOTE:** We advise assistance with lifting the splitter onto the frame.

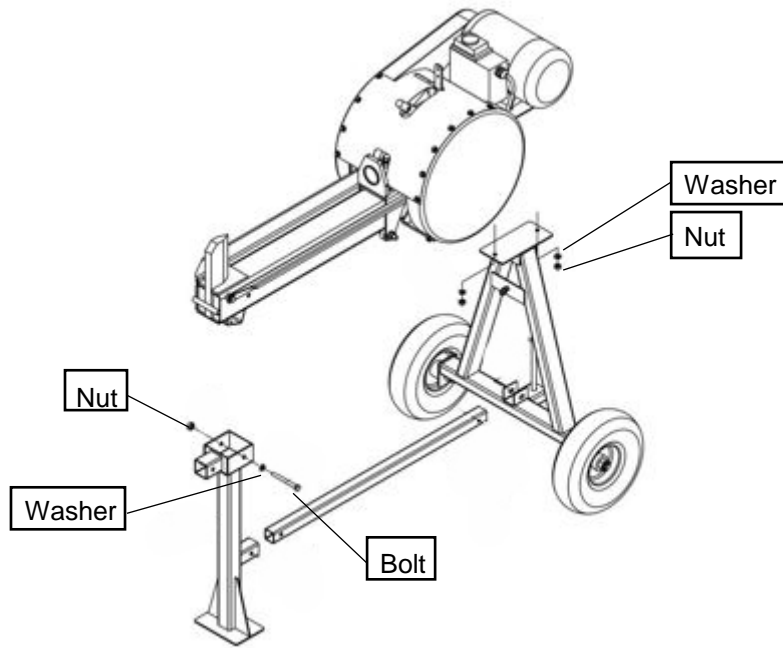

## LOG TRAY ASSEMBLY



### NOTE

The log tray option requires the installation of the taller stand for it to operate.

- 2.8 Attach the log tray support bar/towing attachment\* to the front leg of the frame.

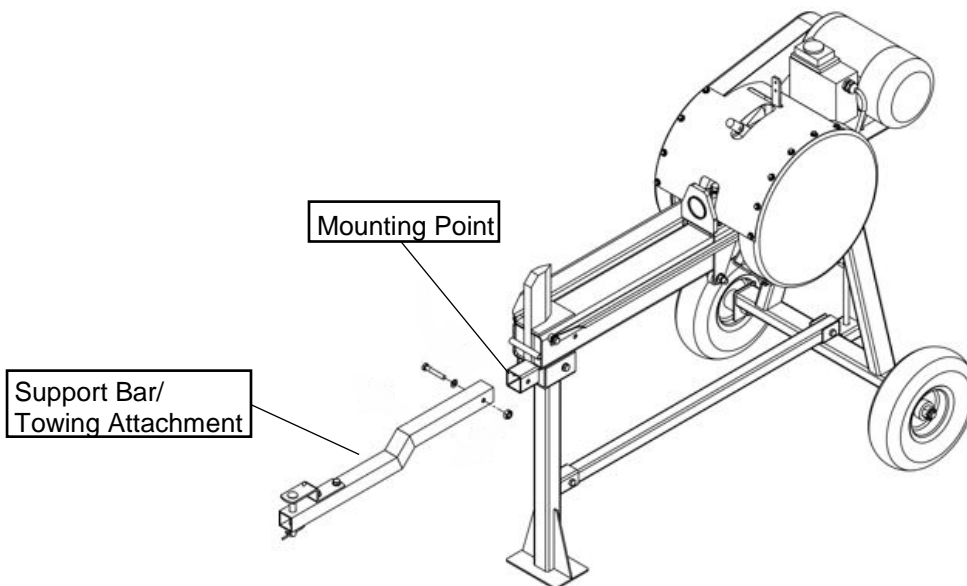

**\*NOTE:** The towing attachment is for farm or forestry vehicles only.  
This log splitter **CAN NOT** be towed on public roads.

- 2.9 Mount the log tray on to the top of the support bar/towing attachment and securely fix in place to the locating holes on the log splitter frame.

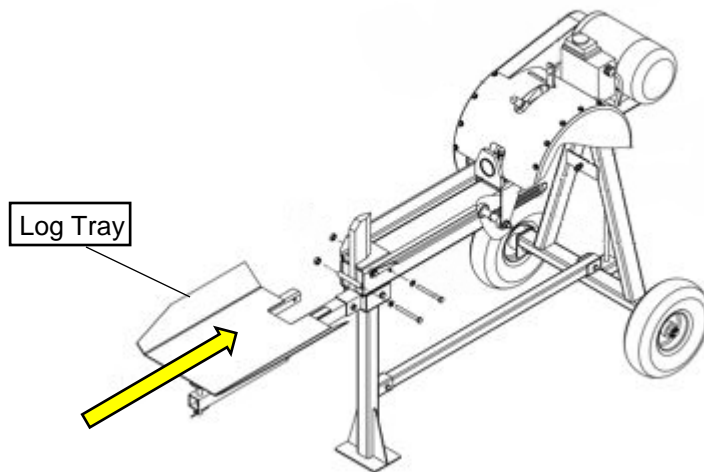

- 2.10 Assemble the rest of the log splitter as per the assembly instructions 2.3 & 2.4.

## 4. USING THE MACHINE



### CAUTION

**ALWAYS** keep hands and feet clear of moving parts and **NEVER** use the machine if any of the safety guards are damaged or missing.



### CAUTION

This log splitter is intended and designed only to split wood. **NEVER** use for any other purposes as this could lead to personal injury and void the warranty.



### NOTE

**MAXIMUM LOG LENGTH IS 41cm**  
**LOG DIAMETER 5cm – 30cm**

3.0 The log splitter should be kept in a horizontal position when in use.

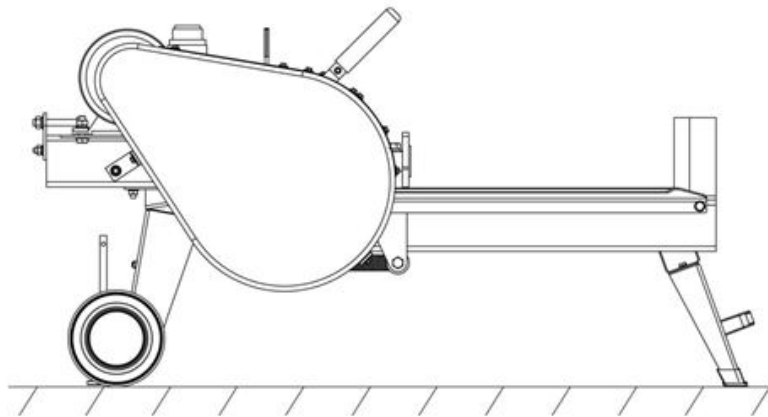

3.1 **ALWAYS** use the rear adjustable support leg when in use.

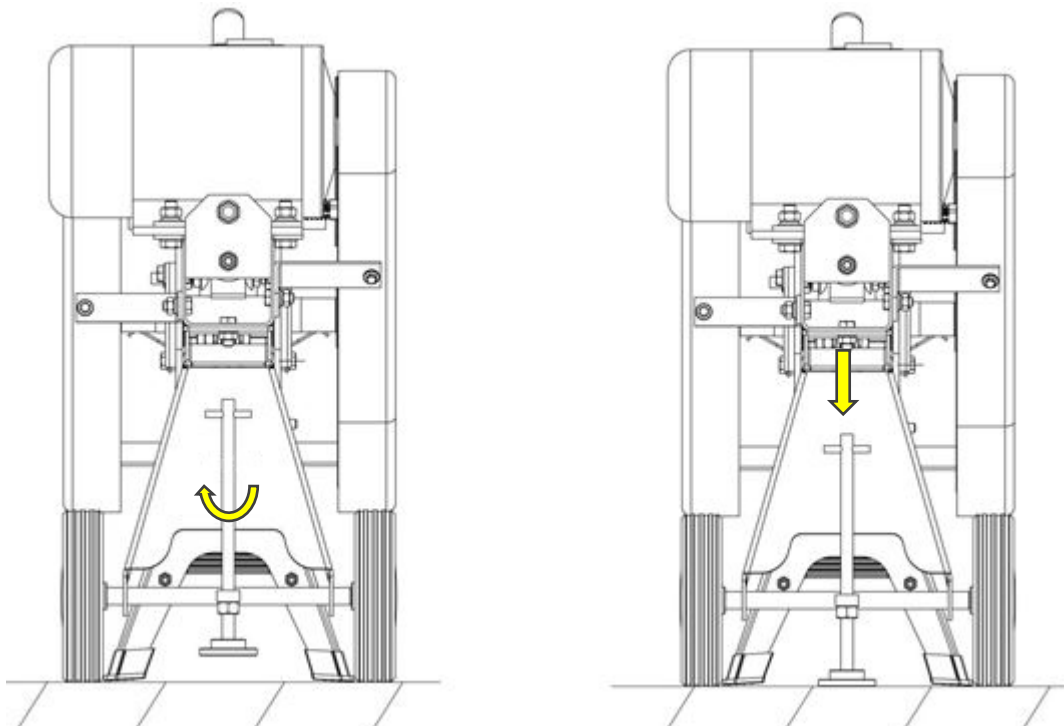



- 3.2 Lubricate the beam area where the splitting wedge will slide with a small amount of engine oil. **DO NOT** use grease.
- 3.3 The log splitter is equipped with a control system that requires the machine to be operated by both hands of the user.
- 3.4 One hand will need to depress the safety handle while the other hand operates the control handle.  
This system keeps both hands clear of moving parts for safe operation.
- 3.5 The log splitter will stop working if either hand is removed.
- 3.6 Release the control lever to allow the log pusher to return to the start position.
- 3.7 **DO NOT** continue to apply pressure once the log has been split, this causes unnecessary stress on the rack teeth.
- 3.8 **DO NOT** place your hands on the ends of the log when loading.  
This is an unsafe method and could result in personal injury.
- 3.9 **DO NOT** reach or step across the rail while the log splitter is running.
- 3.10 **NEVER** attempt to split wood across the grain.  
The log splitter was not designed for cross-grain log splitting and doing so could damage.
- 3.11 Make sure both ends of the logs you are splitting are as square as possible.  
This will prevent the log from slipping out of position while under pressure.
- 3.12 **DO NOT** try and catch the split wood, allow it to fall to the ground.
- 3.13 **DO NOT** attempt to split 2 logs at the same time. One of them may fly up and hit you.
- 3.14 If the ram stops before the log has been split, quickly pull the control lever backwards to prevent stress on the belts.  
Once the ram is free continue to split the log.
- 3.15 If a log becomes jammed, release the controls and return the ram to the start position.
- 3.16 Insert a wedge under the jammed log, start the log splitter to push the wedge under the jammed log.
- 3.17 Repeat above procedure with a sharper slope wedge until the log is completely free.
- 3.18 **DO NOT** hit a jammed log with a hammer to try and remove as this may cause damage to the machine.

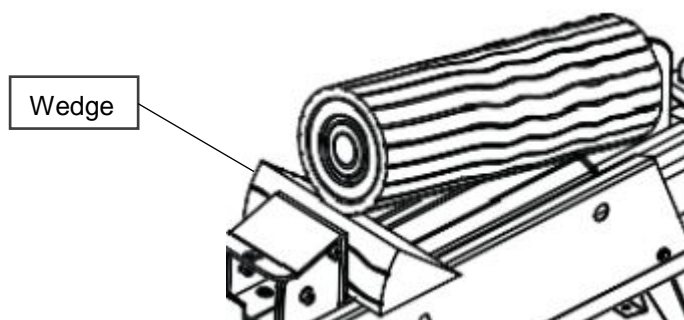

- 3.19 **ALWAYS** keep the guards in place and do not use if a guard is damaged or missing.
- 3.20 **NEVER** force or push the log when splitting.

- 3.21 **ALWAYS** wear the appropriate Personal Protective Equipment (PPE) when using the log splitter.
- 3.22 **NEVER** allow one person to operate the machine while another person loads a log.
- 3.23 **NEVER** attempt to load the log splitter while the ram is in motion.
- 3.24 Extension cables up to 8 meters must be no smaller than 12AWG.  
Extension cables up to 15 meters must be no smaller than 10AWG.

## 5. MAINTENANCE



### WARNING

Before performing any maintenance procedure or inspection, stop the motor, unplug the power cord and wait 5 minutes to allow parts to cool.



### CAUTION

All maintenance and repair work must be carried out by a qualified technician.

Procedure	Before Each Use	Every 5 Hours	Every 25 Hours
Visual inspection for condition	X		
Inspect and maintain rail	X		
Check electrical cord and plug	X		
Check belt	X		
Grease rack		X	
Clean			X

## LUBRICATION

- 4.0 The log splitter uses sealed bearings and should never need any additional lubrication.
- 4.1 To grease the rack, firstly unscrew the drive belt guard and centre guard.

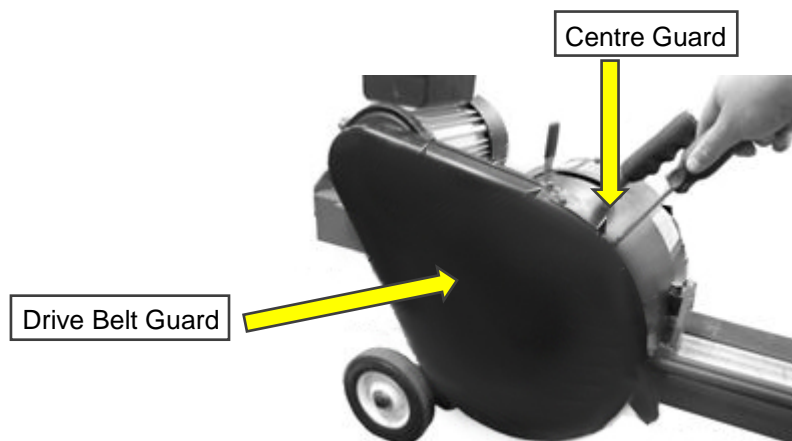

- 4.2 Remove the belt guard and disconnect the return spring from the eye bolt.

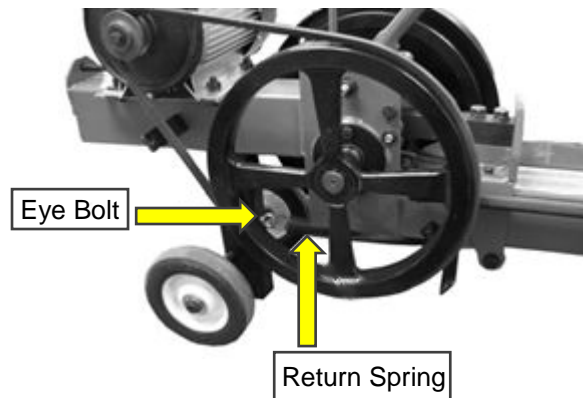

- 4.3 Pull out the rack and grease the rack teeth, topside of the rack and the pinion.

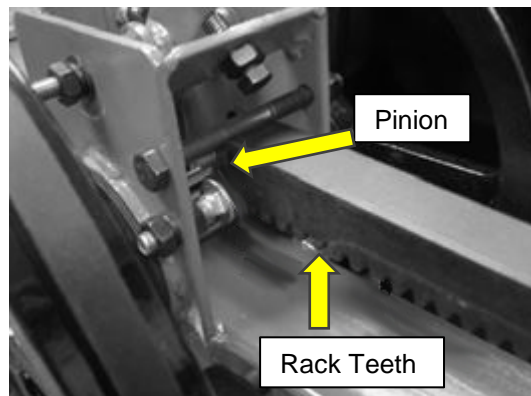

- 4.4 Refit the reverse spring and belt drive cover in the reverse order.

## RAIL MAINTENANCE

- 4.5 Between each use, we recommend removing any debris caught on the rail or ram.
- 4.6 Apply a rust preventative fluid to any bare or exposed metal areas of the rail to prolong the life of the log splitter.

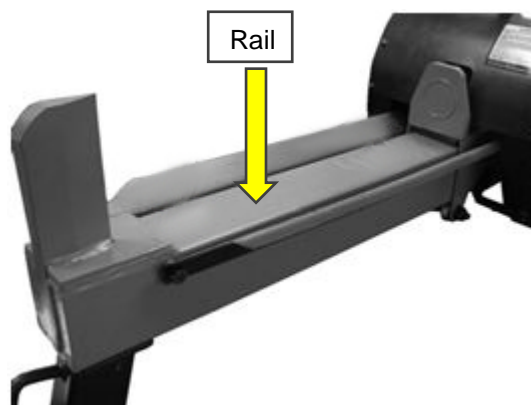

## CHANGING / ADJUSTING THE BELT



### NOTE

The belt performs best with a slight amount of slack as described below to allow for the belt to slip on the pulley when the wedge encounters a tough log. Too much belt tension may cause the motor to stall.

- 4.7 Remove the drive belt and centre guard.
- 4.8 Place a straight edge across the top of the belt.

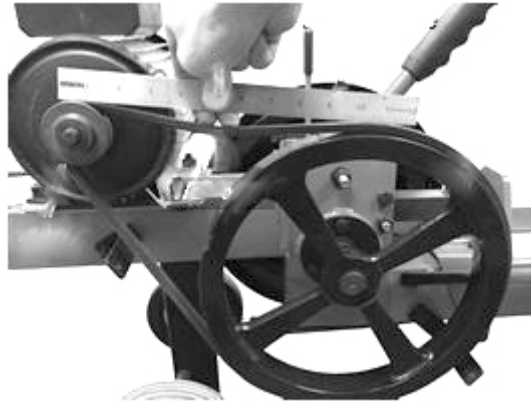

- 4.9 Apply a gentle amount of pressure to the middle of the belt. The belt should deflect around 10 to 15mm.
- 4.10 If the belt does not deflect between these parameters then you will need to adjust the belt.
- 4.11 Loosen the motor mounting nuts.
- 4.12 Turn the tension nut in against the frame to tighten (if the belt is too loose) or out to loosen (if the belt is too tight) for the correct belt tension.
- 4.13 When the belt is at the correct tension, re-tighten the motor mounting nuts and reinstall the belt guards.

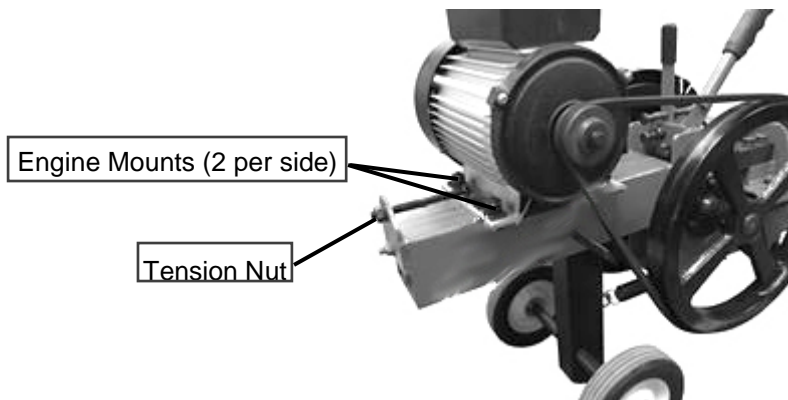

- 4.14 To change the belt, remove the belt drive and centre guard.

- 4.15 Loosen the motor mounting nuts.
- 4.16 Turn the tension nut out to loosen the belt.
- 4.17 Remove the belt and replace with a new one.
- 4.18 Follow the belt adjustment procedure to obtain the correct belt tension.
- 4.19 Replace the belt and centre guards.

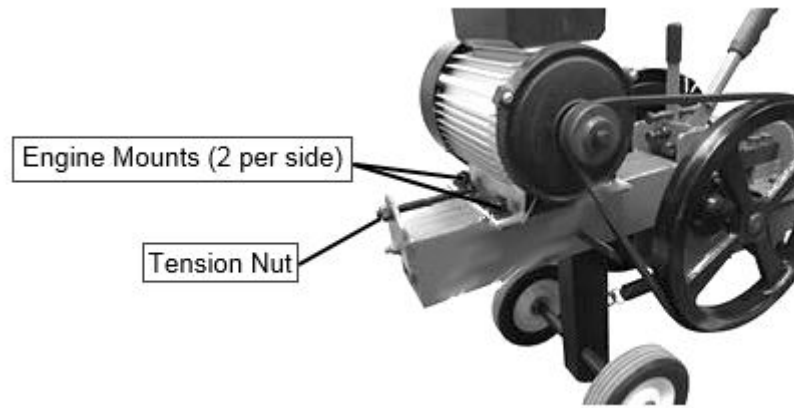

## 6. TROUBLESHOOTING



### WARNING

Before performing any maintenance procedure or inspection, stop the motor, unplug the power cord and wait 5 minutes to allow parts to cool.



### CAUTION

All maintenance and repair work must be carried out by a qualified technician.

Problem	Possible Cause	Possible Solution
Motor does not run	Splitter unplugged	Plug splitter in
	Damaged electrical cord	Take to a service centre for repair
	Splitter circuit breaker has tripped	Reset circuit breaker
	External circuit breaker has tripped	Reset circuit breaker
	Motors Still Will Not Start	Take to a Service Centre for Repair
Motor reset continually trips	Ensure you are supplying the correct voltage to the machine	
	If using an extension cable, make sure the cable is no longer than 8 meters and not smaller than 12AWG or no longer than 15 meters and not smaller than 10AWG	
	The belt is too tight. Check belt tension and adjust accordingly.	
Log fails to split	Incorrect positioning of the log	Re-position the log flat on the splitting beam with the end square against the wedge
	Log exceeds maximum length and diameter	Maximum length is 410mm, Maximum diameter is 300mm
Rack returns slowly or not returning properly	Ram or rail blocked by debris	Remove debris
	Rack lift bearing misaligned	Re-align rack lift bearing
	Interference between ram and tray	Remove interference between ram and tray
	Return spring is unhooked or damaged	Reconnect or replace return spring
Operator lever snapping out of gear or not staying in gear	Lever not all the way in the split position when rack comes under full load	Push lever quicker and with more force into the split position. A hard stop should be felt at the end of the stroke when engaging the handle
	Ram overloaded at lower part of face	Check rack gear for straightness
Ram does not move or slow to move with the motor running and the handle pushed.	Incorrect voltage	Ensure you are supplying the correct voltage to the machine
	If using an extension cable	Make sure the cable is no longer than 8 meters and not smaller than 12AWG or no longer than 15 meters and not smaller than 10AWG



<b>Problem</b>	<b>Possible Cause</b>	<b>Possible Solution</b>
Rack slamming back too fast	Wedge end of the machine too high	Must almost be level with the ram end of just slightly higher
	Springs not operating properly	Fix or replace as needed
Machine does not seem to have full splitting power	Belt tension may be incorrect	Refer to the Maintenance section of the manual for belt tension adjustment
Operator lever not engaging rack with pinion gear	Debris under rack	Clean under rack
	Debris around carriage assembly	Clean around carriage
Rack not disengaging from pinion when handle is released	Belt too tight	Refer to the Maintenance section of the manual on how to adjust belt tension

## 7. SPECIFICATION

Model Number	HYLS7410
Horse Power	2.5
Voltage	230v
Power (watts)	1600w
Cycle Time	2 Seconds
Splitting Force	7 Tonnes
Maximum Log Length	410mm
Log Diameter	50 – 300mm
Dimensions (L x W x H)	1115 x 300 x 582mm
Net Weight	61Kgs

## 8. RECYCLING AND PRODUCT DISPOSAL

- 5.0 We do not offer a takeback scheme for the recovery of Waste Electrical Electronic Equipment (WEEE) & Batteries.  
Instead the responsibility to dispose of WEEE and or Batteries is passed onto you by us.  
So when it becomes necessary to dispose of your machine you must take it to your local Civic Amenity Site.  
For further information please contact your local Authority for disposal advice.
- 5.1 You **MUST** make sure that all unused oil and fuel is disposed of correctly either beforehand or at your local Civic Amenity Site.  
Under NO circumstances must any fuel or oil be put down any drains.
- 5.2 Certain products contain WEEE waste which should not be disposed of in your domestic waste.
- 5.3 You **MUST** recycle WEEE in accordance with your local authority or recycling centre.
- 5.4 Certain products contain batteries which should not be disposed of in your domestic waste.
- 5.5 You **MUST** recycle batteries in accordance with your local authority or recycling centre.
- 5.6 Unwanted packaging and materials should be stored and taken to a recycling centre so it can be disposed of in a manner which is compatible with the environment.
- 5.7 The following symbol means that you should 'Reduce – Reuse – Recycle'.
- 5.8 We are a Member of the VALPAK National Compliance Scheme and our registration number is **RM08660**
- 5.9 For further information about disposal please contact your Local Authority.
- 5.10 You can also get more advice and guidance about recycling at the following website <http://www.recycle-more.co.uk>
- 5.11 Should you pass this product on to another user either sold or loaned, you **MUST** pass on this user manual.  
This will make sure that all other users can use and maintain this machine safely.

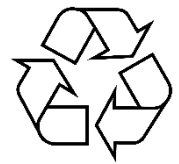
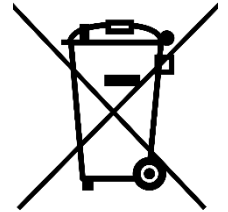

## 9. DECLARATION OF CONFORMITY

6.0 Genpower Ltd confirms that this Hyundai product conforms to the following CE Directives;

2006/42/EC Machinery Directive  
2004/108/EC EMC Directive  
2000/14/EC Amended by 2005/88/EC

### EC DECLARATION OF CONFORMITY

The undersigned. As authorised by: **Genpower Ltd**  
Declares that the following equipment manufactured under licence by Hyundai Korea

Conforms to the Directive:-  
**2000/14/EC (as amended)**

Of the European Parliament and of the council on the approximation of the laws of the Member States relating to the noise emission in the environment by equipment for the use outdoors.

Equipment Category: **Power Equipment**  
Product Name/Model: **HYLS7410**  
Type/Serial No: **Log Splitter**  
Net installed power: **1600w**  
The technical documentation is kept by: **Roland Llewellyn, Genpower Ltd  
Isaac Way, Pembroke Dock,  
Pembrokeshire, SA72 4RW.**

The conformity assessment procedure followed was in accordance with annex V of the Directive.

Notified Body: **Istituto Giordano, Via Gioacchino Rossini  
2 – 47814 Bellaria-Igea Marina  
(RM) Italy  
Certification n° 75406/2116/Crev.1**

Measured Sound Power Level: **83dB**

Guaranteed Sound Power Level: **83dB**

A copy of this certificate has been submitted to the European Commission and the EU Member State United Kingdom.

Place of Declaration: **Pembroke Dock, SA73 4RW**

Date: **08/05/2018**

Signed by: **Roland Llewellyn**



Position in Company: **Managing Director**

Name and address of manufacturer or Authorised representative:

**Genpower Ltd  
Isaac Way, Pembroke Dock,  
Pembrokeshire, SA72 4RW**

## 13. CONTACT DETAILS

7.0	POSTAL ADDRESS	Genpower Ltd, Isaac Way, London Road, Pembroke Dock, Pembrokeshire. SA72 4RW. UK.
7.1	TELEPHONE	+44 (0) 1646 687880
7.2	FAX	+44 (0) 0164 686198
7.3	TECHNICAL EMAIL	aftersales@genpower.co.uk
7.4	WEBSITE	www.hyundaipowerequipment.co.uk

## 14. WARRANTY

To register your machine for the manufacturer's warranty, please visit  
<https://www.hyundaipowerequipment.co.uk/warranty>

## 15. MANUAL UPDATES

- 8.0 Our manuals are constantly being reviewed and updated. However if you find an error, omission or something you find unclear, please contact your dealer for assistance.
- 8.1 Our latest manuals are also placed online.
- 8.2 We reserve the right to make any modifications without prior notice whenever necessary.



**HYUNDAI**  
POWER PRODUCTS

**For Inquiries, Please Contact:**

**GENPOWER LTD**  
Isaac Way, London Road  
Pembroke Dock, UNITED KINGDOM, SA72 4RW  
T: +44 (0) 1646 687 880 F: +44 (0) 1646 686 198  
E: [info@hyundaipowerequipment.co.uk](mailto:info@hyundaipowerequipment.co.uk)  
[www.hyundaipowerequipment.co.uk](http://www.hyundaipowerequipment.co.uk)

Imported/Distributed by GENPOWER LTD

Licensed by Hyundai Corporation, Korea