

Model No.DC10WA CHARGER

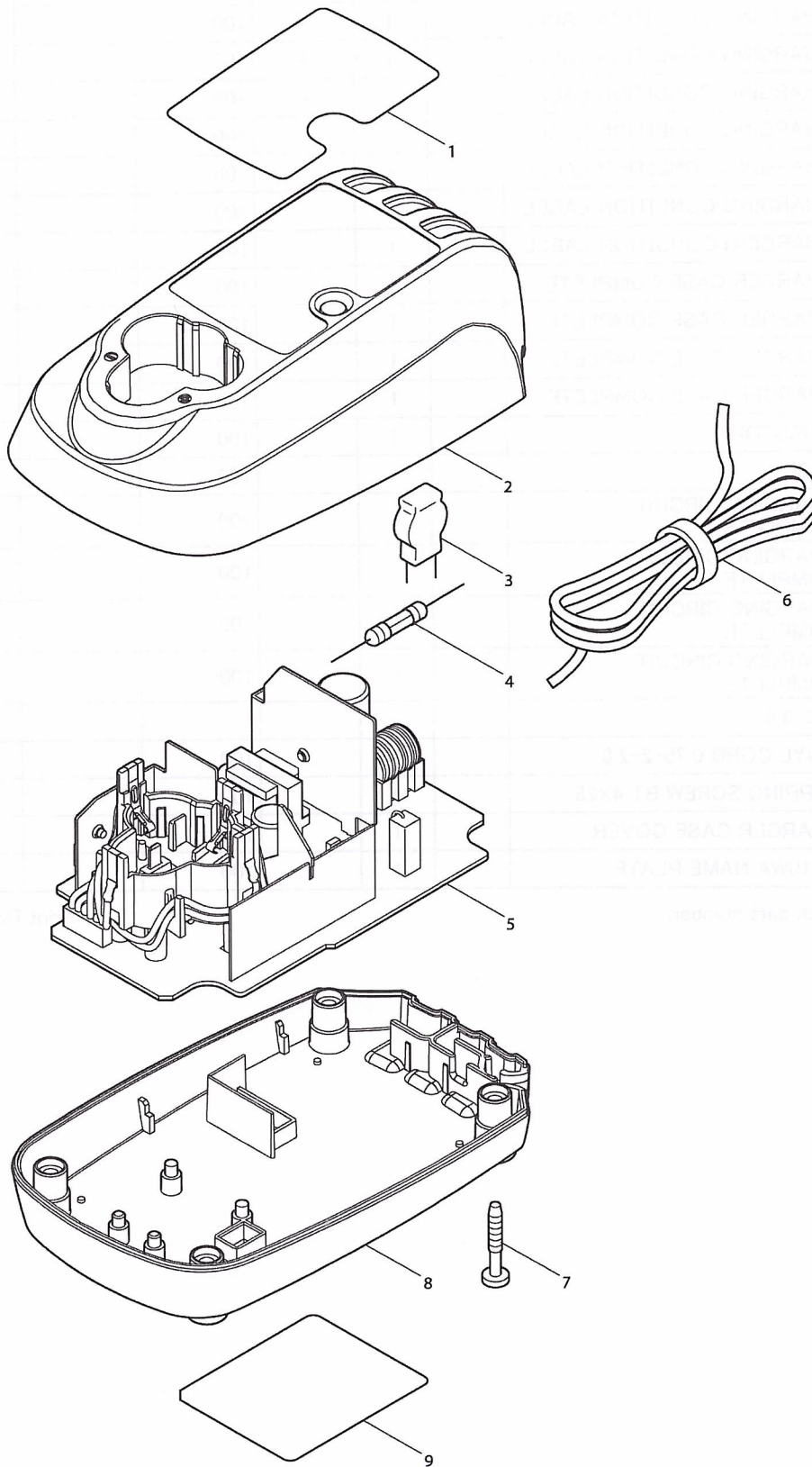

Model No.DC10WA CHARGER

Item	Parts No.	Description	I/C	QTY	New/Old	Opt. 1	Opt. 2	NOTE
001B	806973-3	CHARGING CONDITION LABEL		1	*	100		
001C	806973-3	CHARGING CONDITION LABEL		1	*	100		
001D	808024-8	CHARGING CONDITION LABEL		1	*	100		
001E	808024-8	CHARGING CONDITION LABEL		1	*	100		
001-1B	806973-3	CHARGING CONDITION LABEL	<	1		100		
001-1C	806973-3	CHARGING CONDITION LABEL	<	1		100		
001-1D	806973-3	CHARGING CONDITION LABEL	<	1		100		
001-1E	806973-3	CHARGING CONDITION LABEL	<	1		100		
002B	158599-0	CHARGER CASE COMPLETE		1		100		
002C	158599-0	CHARGER CASE COMPLETE		1		100		
002D	158814-2	CHARGER CASE COMPLETE		1		100		
002E	158814-2	CHARGER CASE COMPLETE		1		100		
003	647306-1	VARISTOR		1		100		
004	652779-5	FUSE		1		100		
005B	631806-1	CHARGING CIRCUIT COMPLETE		1		100		
005C	631806-1	CHARGING CIRCUIT COMPLETE		1		100		
005D	631836-2	CHARGING CIRCUIT COMPLETE		1		100		
005E	631836-2	CHARGING CIRCUIT COMPLETE		1		100		
D10		INC. 3,4						
006	667986-7	VINYL CORD 0.75-2-2.0		1		100		
007	266355-5	TAPPING SCREW BT 4X25		4		100		
008	450470-7	CHARGER CASE COVER		1		100		
009	864956-9	DC10WA NAME PLATE		1		100		

Please order the parts with part number.

Print Date 21/10/2019