



INSTRUCTIONS FOR:  
**RECHARGEABLE INSPECTION LAMP 6W LED**  
**LITHIUM-ION with USB**  
 MODEL NO: **LED176**

Thank you for purchasing a Sealey product. Manufactured to a high standard, this product will, if used according to these instructions and maintained properly, give you years of trouble free performance.

**IMPORTANT:** PLEASE READ THESE INSTRUCTIONS CAREFULLY. NOTE THE SAFE OPERATIONAL REQUIREMENTS, WARNINGS & CAUTIONS. USE THE PRODUCT CORRECTLY AND WITH CARE FOR THE PURPOSE FOR WHICH IT IS INTENDED. FAILURE TO DO SO MAY CAUSE DAMAGE AND/OR PERSONAL INJURY AND WILL INVALIDATE THE WARRANTY. KEEP THESE INSTRUCTIONS SAFE FOR FUTURE USE.



Refer to Instruction  
Manual

### 1. SAFETY

- WARNING! DO NOT** use any other type of charger with this product, other than the supplied mains charger. Failure to observe this warning could result in injury and or fire and will invalidate the warranty.
- WARNING!** It is the user's responsibility to read, understand and comply with the following electrical instructions:  
 You must ensure the risk of electric shock is minimised by the installation of appropriate safety devices.  
 An RCCB (Residual Current Circuit Breaker) should be incorporated in the main distribution board. We also recommend that an RCD (Residual Current Device) is used with all electrical products, particularly portable equipment which is plugged into an electrical supply not protected by an RCCB.
- ✓ You must also read and understand the following instructions concerning electrical safety.  
 The Electricity At Work Act 1989 requires all portable electrical appliances, if used on business premises, to be tested by a competent electrician, using a Portable Appliance Tester (PAT), at least once a year.  
 The Health & Safety at Work Act 1974 makes owners of electrical appliances responsible for the safe condition of the appliance and the safety of the appliance operator. If in any doubt about electrical safety, contact a competent electrician.
- ✓ You must ensure that you inspect the charger plug, cable and connector for wear and damage to ensure items are safe before connecting to the mains power supply. If worn or damaged **DO NOT** use.
- ✓ Check that the voltage marked on the charger plug is the same as the lamp.
- ✓ Uncoil the cable between charger and the lamp.
- ✓ Ensure the lamp is fully charged before initial use.
- ✗ **DO NOT** pull the charger plug from the mains socket by the lead.
- ✗ **DO NOT** try to take the charger plug apart.
- ✗ **DO NOT** use the charger plug to charge or power any other electrical item.
- ✗ **DO NOT** get the charger wet, or use in wet, damp conditions (for indoor use only).
- ✗ **DO NOT** turn the lamp on when it is being charged.
- ✗ **DO NOT** shine directly into your, another person's or an animal's eyes.
- ✗ **DO NOT** allow children to use the lamp.
- ✗ **DO NOT** use the lamp if you suspect that the battery or the lamp casing is damaged.
- ✗ **DO NOT** leave battery in a discharged state, recharge battery immediately. Before storage, fully recharge the battery. Subsequently recharge the battery at least once every six months of non-use.
- ✗ **DO NOT** try to take the charger plug apart.
- ✗ **DO NOT** get the charger wet, or use in wet, damp conditions (for indoor use only).
- ✗ **DO NOT** attempt to open, disassemble, modify or service the battery pack.
- ✗ **DO NOT** crush, puncture, short external contacts or dispose of in fire or water.
- ✗ **DO NOT** expose to temperatures above 60°C (140°).
- ✓ Replace only with the battery pack designated for this product.
- ✓ Recycle or dispose of used battery as stipulated by local regulation.
- If the electrolyte in the cells gets on your skin, thoroughly wash with soap and water. If it gets in your eyes, rinse thoroughly with cool water and seek immediate medical attention.

### 2. INTRODUCTION

Composite aluminium construction rechargeable lead lamp, high output with even spread of light. Features selectable 50% or 100% lighting modes, 360° hanging hook, battery level indicator and USB charging lead.

### 3. SPECIFICATION

Model No:	LED176
Battery:	3.7V 2.2Ah Li-ion
LED Quantity:	20
Lumen Output (High/Low):	400/200lm
Operating Time (High/Low):	2/4hr
Charging Time:	3hr
Length:	465mm
IP Rating:	IP54

## 4. OPERATION

### 4.1. CHARGING

- 4.1.1. The state of charge is indicated by the number of battery charge LEDs (fig.1) lit when the lamp is switched on.. Four LEDs (two greens, amber and red) denote a full charge.
- 4.1.2. As the charge level drops, the number of LEDs lit will drop. When just the red is lit, the lamp needs to be recharged.
- 4.1.3. Plug the micro USB plug into the micro USB port on the base (fig.1).
- 4.1.4. If charging from 230V mains, plug the USB plug into the 230V charger and connect the charger to the mains supply.
- 4.1.5. If charging from a 5V USB outlet, connect the USB plug to the USB socket.
- 4.1.6. During charging, the current state of charge is shown by a flashing LED. When fully charged, all the LEDs will be illuminated.
- 4.1.7. At this point, disconnect from the power supply.

### 4.2. OPERATION

- 4.2.1. Switch the lamp on by means of the on/off button (fig.1). The first press selects reduced power, the second selects full power. Pressing for a third time switches the lamp off.

### 4.3. CLEANING

Clean with a damp cloth. **DO NOT** use abrasive or solvent cleaners.

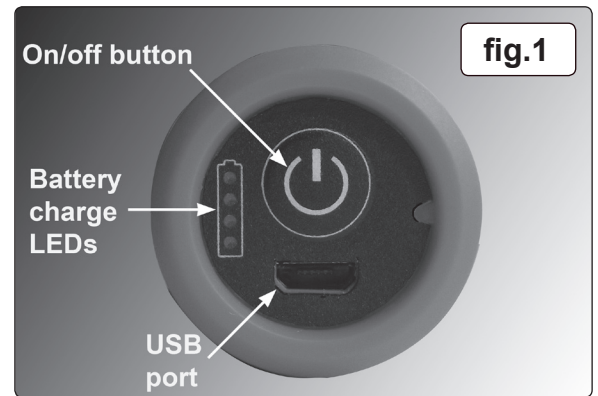

#### Environmental Protection



Recycle unwanted materials instead of disposing of them as waste. All tools, accessories and packaging should be sorted, taken to a recycling centre and disposed of in a manner which is compatible with the environment.

When the product becomes completely unserviceable and requires disposal, drain off any fluids (if applicable) into approved containers and dispose of the product and the fluids according to local regulations.



#### WEEE Regulations

Dispose of this product at the end of its working life in compliance with the EU Directive on Waste Electrical and Electronic Equipment (WEEE). When the product is no longer required, it must be disposed of in an environmentally protective way. Contact your local solid waste authority for recycling information.

**NOTE:** It is our policy to improve products continually and as such we reserve the right to alter data, specifications and component parts without prior notice.

**IMPORTANT:** No liability is accepted for incorrect use of this product.

**WARRANTY:** Guarantee is 12 months from purchase date, proof of which will be required for any claim.



Sole UK Distributor, Sealey Group,  
Kempson Way, Suffolk Business Park,  
Bury St. Edmunds, Suffolk,  
IP32 7AR



01284 757500



01284 703534



[www.sealey.co.uk](http://www.sealey.co.uk)



[sales@sealey.co.uk](mailto:sales@sealey.co.uk)